

101 Raised Toilet Seat Pricelist/Order Form

Effective October 1, 2018

ActiveAid

101 Activeaid Road
Redwood Falls, Mn 56283
ph. 800.533.5330 fax 888.224.8622

Bill To:

Date: _____
P.O.#: _____
Quote#: _____
Account#: _____
Ordered By: _____
Supplier Company: _____
Address: _____
City, State, Zip: _____
Phone: _____
Fax: _____
Email: _____

Ship To:

Name: _____
Address: _____
City/State: _____
Zip: _____
Phone: _____
Fax: _____
Tag For: _____

Email form to orders@activeaid.com
Fax this form to 888.224.8622

Frame

PRT50000 101 Base (white frame color) \$104

Legs (must select one)

PRT50001 Short w/crutch tips (height seat range from floor to bottom frame-15.375"-18.375") \$68
 PRT50002 Short w/suction cups (height seat range from floor to bottom frame-15.375"-18.375") \$140
 PRT50003 Long w/crutch tips (height seat range from floor to bottom frame-18.375"-21.125") \$78
 PRT50004 Long w/suction cups (height seat range from floor to bottom frame-18.375"-21.125") \$145

Seats (must select one)

U-Shaped Seats

P60928 16"Wx16"D Ensolite® (A-4"xB-6.5" opening, 1" foam) \$300
 P60686 16"Wx18"D Ensolite® (A-4.25"xB-7" opening, 2" foam) \$330
 P60811 16"Wx15.5"D Ensolite® (A-3.5"xB-8.75" opening, 2" foam w/1" waterfall foam) \$340
 P60722 18"Wx16"D Ensolite® (A-4.5"xB-7.5" opening, 2" foam) \$330
 P60911 18"Wx18"D Ensolite® (A-4.5"xB-7.5" opening, 1" foam) \$200
 P60913 18"Wx18"D Ensolite® (A-5.5"xB-8" opening, 2" waterfall foam) \$340
 P60993 18"Wx18"D Comfortuff (A-5"xB-8" opening, 1.5" waterfall foam) \$350
 P60850 18"Wx18"D Ensolite® (A-5"xB-8" opening, 1" waterfall foam) \$310

Contoured Front Open Seats

P61063 18"Wx18"D Ensolite® (A-4.25"xB-7.5" opening, 2" contoured dual density foam) \$375
 P61058 18"Wx18"D Ensolite® (A-5.5"xB-8.25" opening, 2" waterfall/contoured foam) \$350

Oval Seat (oval opening)

P60725 18"Wx16"D Ensolite® (7.75"Wx9"D opening, 2" foam) \$330

Solid Seat

P61086 18"Wx18"D Ensolite® (2" foam) \$330

Seat Opening
Measurements

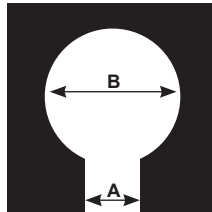

Notes
