

# 1218 Pediatric Rehab Shower/Commode Chair-Tilt

## Package-Price List/Order Form

150 lb. to 350 lb. Weight Capacity\*

Effective May 1, 2019

# ActiveAid

101 Activeaid Road  
Redwood Falls, MN 56283  
ph. 800.533.5330 fax 888.224.8622

### Bill To:

Date: \_\_\_\_\_  
P.O.#: \_\_\_\_\_  
Quote#: \_\_\_\_\_  
Account#: \_\_\_\_\_  
Ordered By: \_\_\_\_\_  
Supplier Company: \_\_\_\_\_  
Address: \_\_\_\_\_  
City, State, Zip: \_\_\_\_\_  
Phone: \_\_\_\_\_  
Email: \_\_\_\_\_

### Ship To:

Name: \_\_\_\_\_  
Address: \_\_\_\_\_  
City/State: \_\_\_\_\_  
Zip: \_\_\_\_\_  
Phone: \_\_\_\_\_  
Tag For: \_\_\_\_\_

Email form to [orders@activeaid.com](mailto:orders@activeaid.com)  
Fax this form to 888.224.8622

### Packages:

#### **PKG214 Package #1-12"Wx12"D Seat** \$4,769

**Package #1-12"Wx12"D Includes: (no substitutions)**

18"Wx18"D Stainless Steel Frame, 4-5" Dual Locking Casters, 12"Wx12"D Ensolite® Front/Rear Open Seat, Left Hand Armrest with Pad, Right Hand Armrest with Pad, Left Pediatric Leg Rest, Right Pediatric Leg Rest, Left Foot Plate, Right Foot Plate, 18"W Adjustable Sling Back, Waist Belt, Calf Strap, Left Hand Swing-Away Adjustable Lateral, Right Hand Swing-Away Adjustable Lateral, Left Hand Arm-Mounted Hip Guide, Right Hand Arm-Mounted Hip Guide, Pan/Hanger, and Head Support-Small.

**Choose Frame Color**  Black  White (if no selection is made, white will be selected)

#### **PKG215 Package #2-14"Wx14"D Seat** \$4,779

**Package #2-14"Wx14"D Includes: (no substitutions)**

18"Wx18"D Stainless Steel Frame, 4-5" Dual Locking Casters, 14"Wx14"D Ensolite® Front/Rear Open Seat, Left Hand Armrest with Pad, Right Hand Armrest with Pad, Left Pediatric Leg Rest, Right Pediatric Leg Rest, Left Foot Plate, Right Foot Plate, 18"W Adjustable Sling Back, Waist Belt, Calf Strap, Left Hand Swing-Away Adjustable Lateral, Right Hand Swing-Away Adjustable Lateral, Left Hand Arm-Mounted Hip Guide, Right Hand Arm-Mounted Hip Guide, Pan/Hanger, and Head Support-Small.

**Choose Frame Color**  Black  White (if no selection is made, white will be selected)

#### **PKG216 Package #3-16"Wx16"D Seat** \$4,239

**Package #3-16"Wx16"D Includes: (no substitutions)**

18"Wx18"D Stainless Steel Frame, 4-5" Dual Locking Casters, 16"Wx16"D Ensolite® Front/Rear Open Seat, Left Hand Armrest with Pad, Right Hand Armrest with Pad, Left Gooseneck Leg Rest, Right Gooseneck Leg Rest, Left Foot Plate, Right Foot Plate, 18"W Adjustable Sling Back, Waist Belt, Calf Strap, Left Hand Swing-Away Adjustable Lateral, Right Hand Swing-Away Adjustable Lateral, Pan/Hanger, and Head Support-Large.

**Choose Frame Color**  Black  White (if no selection is made, white will be selected)

#### **PKG217 Package #4-18"Wx18"D Seat** \$4,364

**Package #4-18"Wx18"D Includes: (no substitutions)**

18"Wx18"D Stainless Steel Frame, 4-5" Dual Locking Casters, 18"Wx18"D Ensolite® Front/Rear Open Seat, Left Hand Armrest with Pad, Right Hand Armrest with Pad, Left Gooseneck Leg Rest, Right Gooseneck Leg Rest, Left Foot Plate, Right Foot Plate, 18"W Adjustable Sling Back, Waist Belt, Calf Strap, Left Hand Swing-Away Adjustable Lateral, Right Hand Swing-Away Adjustable Lateral, Pan/Hanger, and Head Support-Large.

**Choose Frame Color**  Black  White (if no selection is made, white will be selected)

#### Seat Opening Measurements

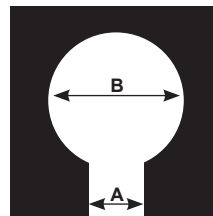

#### \* Weight Capacity for Seats

12"Wx12"D - 150lbs.  
14"Wx14"D - 250lbs.  
16"Wx16"D - 300lbs.  
18"Wx18"D - 350lbs.