

# 101 Rehab Shower/Commode Chair-Bath/Toilet Modular System

Package-Order Form  
350 lb. Weight Capacity  
Effective July 20, 2022

# ActiveAid

101 Activeaid Road  
Redwood Falls, MN 56283  
ph. 800.533.5330 fax 888.224.8622

## Bill To:

Date: \_\_\_\_\_  
P.O.#: \_\_\_\_\_  
Quote#: \_\_\_\_\_  
Account#: \_\_\_\_\_  
Ordered By: \_\_\_\_\_  
Supplier Company: \_\_\_\_\_  
Address: \_\_\_\_\_  
City, State, Zip: \_\_\_\_\_  
Phone: \_\_\_\_\_  
Email: \_\_\_\_\_

## Ship To:

Name: \_\_\_\_\_  
Address: \_\_\_\_\_  
City/State: \_\_\_\_\_  
Zip: \_\_\_\_\_  
Phone: \_\_\_\_\_  
Tag For: \_\_\_\_\_

**Email form to [orders@activeaid.com](mailto:orders@activeaid.com)  
Fax this form to 888.224.8622**

## Packages:

### PKG110 Package #3

\$660

**Package #3 Includes: (no substitutions)**

18"Wx18"D White Stainless Steel Frame, Short Legs w/Crutch Tips, and Seat.

#### Seats- must select one

- P60928** 16"Wx16"D Ensolite® Front/Rear Open Seat\*  
(A-4"xB-6.5" opening, 1" foam)
- P60686** 16"Wx18"D Ensolite® Front/Rear Open Seat\*  
(A-4.25"xB-7" opening, 2" foam)
- P60811** 16"Wx15.5"D Ensolite® Front/Rear Open Seat\*  
(A-3.5"xB-6" opening, 2" waterfall foam)
- P60722** 18"Wx16"D Ensolite® Front/Rear Open Seat\*  
(A-4.5"xB-7.5" opening, 2" foam)
- P60913** 18"Wx18"D Ensolite® Front/Rear Open Seat\*  
(A-5.25"xB-8" opening, 2" waterfall foam)
- P60993** 18"Wx18"D Comfortuff Front/Rear Open Seat\* (DEFAULT CHOICE)  
(A-5"xB-8" opening, 2.5" waterfall foam)
- P60850** 18"Wx18"D Ensolite® Front/Rear Open Seat\*  
(A-5"xB-8" opening, 1" waterfall foam)
- P61063** 18"Wx18"D Ensolite® Front Open Contoured Seat  
(A-4.25"xB-7.5" opening, 2" foam)
- P61058** 18"Wx18"D Ensolite® Front Open Contoured Seat  
(A-5.5"xB-8.25" opening, 2" waterfall foam)
- P60725** 18"Wx16"D Ensolite® Oval Seat  
(A-7.75"xB-9", 2" foam)
- P61086** 18"Wx18"D Ensolite® Solid Seat  
(2" foam)

\*Seat works in all 4 positions

### PKG111 Package #4

\$660

**Package #4 Includes: (no substitutions)**

18"Wx18"D White Stainless Steel Frame, Short Legs w/Suction Cups, and Seat.

#### Seats- must select one

- P60928** 16"Wx16"D Ensolite® Front/Rear Open Seat\*  
(A-4"xB-6.5" opening, 1" foam)
- P60686** 16"Wx18"D Ensolite® Front/Rear Open Seat\*  
(A-4.25"xB-7" opening, 2" foam)
- P60811** 16"Wx15.5"D Ensolite® Front/Rear Open Seat\*  
(A-3.5"xB-6" opening, 2" waterfall foam)
- P60722** 18"Wx16"D Ensolite® Front/Rear Open Seat\*  
(A-4.5"xB-7.5" opening, 2" foam)
- P60913** 18"Wx18"D Ensolite® Front/Rear Open Seat\*  
(A-5.25"xB-8" opening, 2" waterfall foam)
- P60993** 18"Wx18"D Comfortuff Front/Rear Open Seat\* (DEFAULT CHOICE)  
(A-5"xB-8" opening, 2.5" waterfall foam)
- P60850** 18"Wx18"D Ensolite® Front/Rear Open Seat\*  
(A-5"xB-8" opening, 1" waterfall foam)
- P61063** 18"Wx18"D Ensolite® Front Open Contoured Seat  
(A-4.25"xB-7.5" opening, 2" foam)
- P61058** 18"Wx18"D Ensolite® Front Open Contoured Seat  
(A-5.5"xB-8.25" opening, 2" waterfall foam)
- P60725** 18"Wx16"D Ensolite® Oval Seat  
(A-7.75"xB-9", 2" foam)
- P61086** 18"Wx18"D Ensolite® Solid Seat  
(2" foam)

\*Seat works in all 4 positions

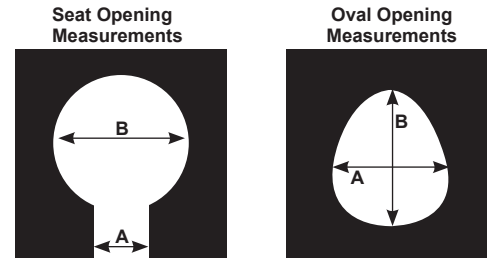

# 202 Rehab Shower/Commode Chair-Bath/Toilet Modular System Package-Order Form

350 lb. Weight Capacity

Effective July 20, 2022

# ActiveAid

101 Activeaid Road  
Redwood Falls, MN 56283  
ph. 800.533.5330 fax 888.224.8622

## Bill To:

Date: \_\_\_\_\_  
P.O.#: \_\_\_\_\_  
Quote#: \_\_\_\_\_  
Account#: \_\_\_\_\_  
Ordered By: \_\_\_\_\_  
Supplier Company: \_\_\_\_\_  
Address: \_\_\_\_\_  
City, State, Zip: \_\_\_\_\_  
Phone: \_\_\_\_\_  
Email: \_\_\_\_\_

## Ship To:

Name: \_\_\_\_\_  
Address: \_\_\_\_\_  
City/State: \_\_\_\_\_  
Zip: \_\_\_\_\_  
Phone: \_\_\_\_\_  
Tag For: \_\_\_\_\_

**Email form to [orders@activeaid.com](mailto:orders@activeaid.com)  
Fax this form to 888.224.8622**

## Packages:

### **PKG103 Package #1** \$1,305

**Package #1 Includes: (no substitutions)**

18"Wx18"D White Stainless Steel Frame, Legs w/Crutch Tips, 18"Wx18"D Ensolite® Front/Rear Open Seat, Back Tubes w/Solid Back Pad, Left Hand Armrest with Pad and Right Hand Armrest with Pad.

### **PKG104 Package #2** \$1,535

**Package #2 Includes: (no substitutions)**

18"Wx18"D White Stainless Steel Frame, Legs w/Crutch Tips, Back Tubes w/Solid Back Pad, Seat, Armrest with Pad, and Bench.

**Seats- must select one**

- P60993** 18"Wx18"D Comfortuff Front/Rear Open Seat\* (DEFAULT CHOICE)  
(A-5"xB-8" opening, 2.5" waterfall foam)
- P60913** 18"Wx18"D Ensolite® Front/Rear Open Seat\*  
(A-5.25"xB-8" opening, 2" waterfall foam)
- P61086** 18"Wx18"D Ensolite® Solid Seat  
(2" foam)
- P61058** 18"Wx18"D Ensolite® Front Open Seat  
(A-5.5"xB-8.25" opening, 2" waterfall/contoured foam)
- P60850** 18"Wx18"D Ensolite® Front/Rear Open Seat\*  
(A-5"xB-8" opening, 1" waterfall foam)

**\*Seat works in all 4 positions**

**Benches- must select one**

- P13294** B-O Transfer Bench (DEFAULT CHOICE)
- P13352** Short Transfer Bench

### **PKG105 Package #3** \$1,535

**Package #3 Includes: (no substitutions)**

18"Wx18"D White Stainless Steel Frame, Legs w/Suction Cups, and Back Tubes w/Solid Back Pad, Seat, Armrest with Pad and Bench.

**Seats- must select one**

- P60993** 18"Wx18"D Comfortuff Front/Rear Open Seat\* (DEFAULT CHOICE)  
(A-5"xB-8" opening, 2.5" waterfall foam)
- P60913** 18"Wx18"D Ensolite® Front/Rear Open Seat\*  
(A-5.25"xB-8" opening, 2" waterfall foam)
- P61086** 18"Wx18"D Ensolite® Solid Seat  
(2" foam)
- P61058** 18"Wx18"D Ensolite® Front Open Seat  
(A-5.5"xB-8.25" opening, 2" waterfall/contoured foam)
- P60850** 18"Wx18"D Ensolite® Front/Rear Open Seat\*  
(A-5"xB-8" opening, 1" waterfall foam)

**\*Seat works in all 4 positions**

**Benches- must select one**

- P13294** B-O Transfer Bench (DEFAULT CHOICE)
- P13352** Short Transfer Bench

**Seat Opening Measurements**

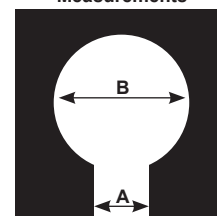

# 285 Rehab Shower/Commode Chair-Tilt Package-Order Form

350 lb. Weight Capacity  
Effective July 20, 2022

# ActiveAid

101 Activeaid Road  
Redwood Falls, MN 56283  
ph. 800.533.5330 fax 888.224.8622

## Bill To:

Date: \_\_\_\_\_  
P.O.#: \_\_\_\_\_  
Quote#: \_\_\_\_\_  
Account#: \_\_\_\_\_  
Ordered By: \_\_\_\_\_  
Supplier Company: \_\_\_\_\_  
Address: \_\_\_\_\_  
City, State, Zip: \_\_\_\_\_  
Phone: \_\_\_\_\_  
Email: \_\_\_\_\_

## Ship To:

Name: \_\_\_\_\_  
Address: \_\_\_\_\_  
City/State: \_\_\_\_\_  
Zip: \_\_\_\_\_  
Phone: \_\_\_\_\_  
Tag For: \_\_\_\_\_

**Email form to [orders@activeaid.com](mailto:orders@activeaid.com)  
Fax this form to 888.224.8622**

## Packages:

### PKG203 Package #1-16"Wx18"D \$3,959

**Package #1-16"Wx18"D Includes: (no substitutions)**

16"Wx18"D Stainless Steel Frame, 4-5" Dual Locking Casters, 16"Wx18"D Ensolite® Front/Rear Open Seat, Left Hand Armrest with Pad, Right Hand Armrest with Pad, Left Gooseneck Leg Rest, Right Gooseneck Leg Rest, Left Foot Plate with Heel Loop, Right Foot Plate with Heel Loop, 16"W Adjustable Sling Back, Waist Belt, Calf Strap, Bodypoint® Trunk Belt, Pan/Hanger, Head Support-Large.

**Choose Frame Color**    Black    White (if no selection is made, white will be selected)

### PKG204 Package #2-18"Wx18"D 4,074

**Package #2-18"Wx18"D Includes: (no substitutions)**

18"Wx18"D Stainless Steel Frame, 4-5" Dual Locking Casters, Seat, Left Hand Armrest with Pad, Right Hand Armrest with Pad, Left Gooseneck Leg Rest, Right Goosneck Leg Rest, Left Foot Plate with Heel Loop, Right Foot Plate with Heel Loop, 18"W Adjustable Sling Back, Waist Belt, Calf Strap, Bodypoint® Trunk Belt, Pan/Hanger, Head Support-Large.

**Seats- must select one**

- P60993** 18"Wx18"D Comfortuff Front/Rear Open Seat (DEFAULT CHOICE)  
(A-5"xB-8" opening, 2.5" waterfall foam)
- P60974** 18"Wx18"D Comfortuff Contoured Front Open Seat  
(A-4"xB-6.5" opening, sloped foam)
- P60802** 18"Wx18"D Ensolite® Front Open Ring Seat  
(A-4.5"xB-7.75" opening, 1.25" foam)

**Choose Frame Color**    Black    White (if no selection is made, white will be selected)

### PKG205 Package #3-20"Wx18"D \$4,620

**Package #3-20"Wx18"D Includes: (no substitutions)**

20"Wx18"D Stainless Steel Frame, 4-5" Dual Locking Casters, Seat, Left Hand Armrest with Pad, Right Hand Armrest with Pad, Left Gooseneck Leg Rest, Right Goosneck Leg Rest, Left Foot Plate with Heel Loop, Right Foot Plate with Heel Loop, 20"W Adjustable Sling Back, Waist Belt, Calf Strap, Bodypoint® Trunk Belt, Pan/Hanger, Head Support-Large.

**Seats- must select one**

- P61038** 20"Wx18"D Comfortuff Front Open Seat (DEFAULT CHOICE)  
(A-5"xB-8" opening, 1.5" waterfall foam)
- P60903** 20"Wx18"D Ensolite® Front/Rear Open Seat  
(A-4.5"xB-7.75" opening, 1" foam)

**Choose Frame Color**    Black    White (if no selection is made, white will be selected)

### PKG206 Package #4-22"Wx18"D \$4,945

**Package #4-22"Wx18"D Includes: (no substitutions)**

22"Wx18"D Stainless Steel Frame, 4-5" Dual Locking Casters, Seat, Left Hand Armrest with Pad, Right Hand Armrest with Pad, Left Gooseneck Leg Rest, Right Goosneck Leg Rest, Left Foot Plate with Heel Loop, Right Foot Plate with Heel Loop, 22"W Adjustable Sling Back, Waist Belt, Calf Strap, Bodypoint® Trunk Belt, Pan/Hanger, Head Support-Large.

**Choose Frame Color**    Black    White (if no selection is made, white will be selected)

### PKG207 Package #5-18"Wx18"D \$4,806

**Package #5-18"Wx18"D Includes: (no substitutions)**

18"Wx18"D Stainless Steel Frame, 24" Solid Shallow Tread Wheels, Bolted Axles with Anti-Tipping Lever, Wheel Locks, 5" Dual Locking Casters, Seat, Left Hand Armrest with Arm Trough, Right Hand Armrest with Arm Trough, Left Gooseneck Leg Rest, Right Goosneck Leg Rest, Left Foot Plate with Heel Loop, Right Foot Plate with Heel Loop, 18"W Adjustable Sling Back, Waist Belt, Calf Strap, Bodypoint® Trunk Belt, Pan/Hanger, Head Support-Large.

**Seats- must select one**

- P60993** 18"Wx18"D Comfortuff Front/Rear Open Seat (DEFAULT CHOICE)  
(A-5"xB-8" opening, 2.5" waterfall foam)
- P60974** 18"Wx18"D Comfortuff Contoured Front Open Seat  
(A-4"xB-6.5" opening, sloped foam)
- P60802** 18"Wx18"D Ensolite® Front Open Ring Seat  
(A-4.5"xB-7.75" opening, 1.25" foam)

**Choose Frame Color**    Black    White (if no selection is made, white will be selected)

### PKG208 Package #6-18"Wx18"D \$5,754

**Package #6-18"Wx18"D Includes: (no substitutions)**

18"Wx18"D Stainless Steel Frame, 4-5" Dual Locking Casters, Seat, Left Hand Armrest with Arm Trough, Right Hand Armrest with Arm Trough, Left Elevating Leg Rest, Right Elevating Leg Rest, Left Foot Plate with Heel Loop, Right Foot Plate with Heel Loop, 18"W Adjustable Sling Back, Waist Belt, Bodypoint® Trunk Belt, Left Hand Swing-Away Adjustable Lateral, Right Hand Swing-Away Adjustable Lateral Pan/Hanger, Head Support-Large.

**Seats- must select one**

- P60993** 18"Wx18"D Comfortuff Front/Rear Open Seat (DEFAULT CHOICE)  
(A-5"xB-8" opening, 2.5" waterfall foam)
- P60974** 18"Wx18"D Comfortuff Contoured Front Open Seat  
(A-4"xB-6.5" opening, sloped foam)
- P60802** 18"Wx18"D Ensolite® Front Open Ring Seat  
(A-4.5"xB-7.75" opening, 1.25" foam)

**Choose Frame Color**    Black    White (if no selection is made, white will be selected)

**Front Open Seat  
Opening Measurements**

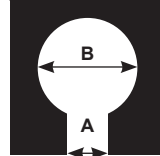

**Race Track Oval  
Opening Measurements**

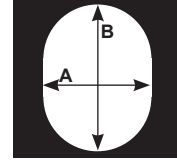

# 285TR Rehab Shower/Commode Chair-Tilt, Recline, Seat Height Adjustment Package-Order Form

350 lb. Weight Capacity

Effective July 20, 2022

# ActiveAid

101 Activeaid Road  
Redwood Falls, MN 56283  
ph. 800.533.5330 fax 888.224.8622

## Bill To:

Date: \_\_\_\_\_  
P.O.#: \_\_\_\_\_  
Quote#: \_\_\_\_\_  
Account#: \_\_\_\_\_  
Ordered By: \_\_\_\_\_  
Supplier Company: \_\_\_\_\_  
Address: \_\_\_\_\_  
City, State, Zip: \_\_\_\_\_  
Phone: \_\_\_\_\_  
Email: \_\_\_\_\_

## Ship To:

Name: \_\_\_\_\_  
Address: \_\_\_\_\_  
City/State: \_\_\_\_\_  
Zip: \_\_\_\_\_  
Phone: \_\_\_\_\_  
Tag For: \_\_\_\_\_

**Email form to [orders@activeaid.com](mailto:orders@activeaid.com)  
Fax this form to 888.224.8622**

## Packages:

### PKG209 Package #1-16"Wx18"D \$5,358

**Package #1-16"Wx18"D Includes: (no substitutions)**

16"Wx18"D Stainless Steel Frame, Tilt/Recline, 4-5" Dual Locking Casters, 16"Wx18"D Ensolite® Front Open Seat, 18"D Left Hand Armrest with Arm Trough, 18"D Right Hand Armrest with Arm Trough, Left Leg Rest, Right Leg Rest, Left Foot Plate with Heel Loop, Right Foot Plate with Heel Loop, 16"W Sling Back, Waist Belt, Calf Strap, Bodypoint® Trunk Belt, Pan/Hanger, Head Support-Large.

**Choose Frame Color**    Black    White (if no selection is made, white will be selected)

### PKG210 Package #2-18"Wx18"D \$5,388

**Package #2-18"Wx18"D Includes: (no substitutions)**

18"Wx18"D Stainless Steel Frame, Tilt/Recline, 4-5" Dual Locking Casters, Seat, 18"D Left Hand Armrest with Arm Trough, 18"D Right Hand Armrest with Arm Trough, Left Leg Rest, Right Leg Rest, Left Foot Plate with Heel Loop, Right Foot Plate with Heel Loop, 18"W Sling Back, Waist Belt, Calf Strap, Bodypoint® Trunk Belt, Pan/Hanger, Head Support-Large.

**Seats- must select one**

- P60993** 18"Wx18"D Comfortuff Front/Rear Open Seat (DEFAULT CHOICE)  
(A-5"xB-8D opening, 2.5" waterfall foam)
- P60974** 18"Wx18"D Comfortuff Contoured Front Open Seat  
(A-4"xB-6.5" opening, sloped foam)
- P61058** 18"Wx18"D Ensolite® Front Open Contoured Seat  
(A-5.5"xB-8.25" opening, 2" waterfall foam)

\*Seat works in all 4 positions

**Choose Frame Color**    Black    White (if no selection is made, white will be selected)

### PKG211 Package #3-18"Wx20"D \$5,964

**Package #3-18"Wx20"D Includes: (no substitutions)**

18"Wx20"D Stainless Steel Frame, Tilt/Recline, 4-5" Dual Locking Casters, Seat, 20"D Left Hand Armrest with Arm Trough, 20"D Right Hand Armrest with Arm Trough, Left Leg Rest, Right Leg Rest, Left Foot Plate with Heel Loop, Right Foot Plate with Heel Loop, 18"W Sling Back, Waist Belt, Calf Strap, Bodypoint® Trunk Belt, Pan/Hanger, Head Support-Large.

**Seats- must select one**

- P61121** 18"Wx20"D Ensolite® Front/Rear Open Seat (DEFAULT CHOICE)  
(A-4.5"xB-7.5" opening, 1" foam)
- PP61038** 18"Wx20"D Comfortuff Side Open Seat  
(A-5"xB-8" opening, 1.5" waterfall foam)

**Choose Frame Color**    Black    White (if no selection is made, white will be selected)

### PKG212 Package #4-20"Wx18"D \$6,484

**Package #4-20"Wx18"D Includes: (no substitutions)**

20"Wx18"D Stainless Steel Frame, Tilt/Recline, 4-5" Dual Locking Casters, Seat, 18"D Left Hand Armrest with Arm Trough, 18"D Right Hand Armrest with Arm Trough, Left Leg Rest, Right Leg Rest, Left Foot Plate with Heel Loop, Right Foot Plate with Heel Loop, 20"W Sling Back, Waist Belt, Calf Strap, Bodypoint® Trunk Belt, Pan/Hanger, Head Support-Large.

**Seats- must select one**

- P61038** 20"Wx18"D Comfortuff Front Open Seat (DEFAULT CHOICE)  
(A-5"xB-8" opening, 1.5" waterfall foam)
- PP60903** 20"Wx18"D Ensolite® Front/Rear Seat  
(A-4.5"xB-7.5" opening, 1" foam)
- PP61121** 20"Wx18"D Ensolite® Side Open Seat  
(A-4.5"xB-7.5" opening, 1" foam)

**Choose Frame Color**    Black    White (if no selection is made, white will be selected)

### PKG213 Package #5-22"Wx18"D \$7,415

**Package #5-22"Wx18"D Includes: (no substitutions)**

22"Wx18"D Stainless Steel Frame, Tilt/Recline, 4-5" Dual Locking Casters, 22"Wx18"D Ensolite® Front/Rear Open Seat, 18"D Left Hand Armrest with Arm Trough, 18"D Right Hand Armrest with Arm Trough, Left Leg Rest, Right Leg Rest, Left Foot Plate with Heel Loop, Right Foot Plate with Heel Loop, 22"W Sling Back, Waist Belt, Calf Strap, Bodypoint® Trunk Belt, Pan/Hanger, Head Support-Large.

**Choose Frame Color**    Black    White (if no selection is made, white will be selected)

**Seat Opening Measurements**

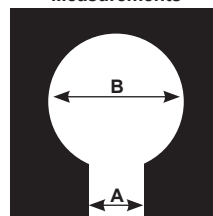

# 600 Rehab Shower/Commode Chair

## Package-Order Form

350 lb. Weight Capacity

Effective July 20, 2022

# ActiveAid

101 Activeaid Road  
Redwood Falls, MN 56283  
ph. 800.533.5330 fax 888.224.8622

### Bill To:

Date: \_\_\_\_\_  
P.O.#: \_\_\_\_\_  
Quote#: \_\_\_\_\_  
Account#: \_\_\_\_\_  
Ordered By: \_\_\_\_\_  
Supplier Company: \_\_\_\_\_  
Address: \_\_\_\_\_  
City, State, Zip: \_\_\_\_\_  
Phone: \_\_\_\_\_  
Email: \_\_\_\_\_

### Ship To:

Name: \_\_\_\_\_  
Address: \_\_\_\_\_  
City/State: \_\_\_\_\_  
Zip: \_\_\_\_\_  
Phone: \_\_\_\_\_  
Tag For: \_\_\_\_\_

Email form to [orders@activeaid.com](mailto:orders@activeaid.com)

Fax this form to 888.224.8622

### Packages:

#### PKG405 Package #1-18"Wx18"D-5" Casters Front and Rear \$2,436

##### Package #1-18"Wx18"D Includes: (no substitutions)

18"Wx18"D Stainless Steel Frame, 4-5" Dual Locking Casters, Seat, 18"D Left Hand Armrest with Pad, 18"D Right Hand Armrest with Pad, Left Gooseneck Leg Rest, Right Gooseneck Leg Rest, Left Foot Plate, Right Foot Plate, 18"W Solid Back, Waist Belt, and Pan/Hanger.

##### Seats- must select one

- P60993 18"Wx18"D Comfortuff Front/Rear Open Seat\* (DEFAULT CHOICE)  
(A-5"xB-8" opening, 2.5" waterfall foam)
- P60974 18"Wx18"D Comfortuff Contoured Front Open Seat  
(A-4"xB-6.5" opening, sloped foam)
- P60701 18"Wx18"D Ensolite® Front/Rear Open Seat\*  
(A-4.5"xB-7.75", 1" foam)
- P61058 18"Wx18"D Ensolite® Front Open Contoured Seat  
(A-5.5"xB-8.25" opening, 2" waterfall foam)
- P60675 18"Wx18"D Ensolite® Cloverleaf Seat  
(7.5"x9" oval opening, 1" foam)
- P60913 18"Wx18"D Ensolite® Front/Rear Open Seat\*  
(A-5.25"xB-8" opening, 2" waterfall foam)

\*Seat works in all 4 positions

Choose Frame Color  Black  White (if no selection is made, white will be selected)

#### PKG406 Package #2-18"Wx18"D-24" Solid Shallow Tread Wheels \$3,032

##### Package #2-18"Wx18"D Includes: (no substitutions)

18"Wx18"D Stainless Steel Frame, 24" Solid Shallow Tread Wheels, 5" Casters, Bolted Axles with Wheel Mounts and Anti-Tipping Levers, Wheel Locks, Seat, 18"D Left Hand Armrest with Pad, 18"D Right Hand Armrest with Pad, Left Gooseneck Leg Rest, Right Gooseneck Leg Rest, Left Foot Plate, Right Foot Plate, 18"W Solid Back, Waist Belt, and Pan/Hanger.

##### Seats- must select one

- P60993 18"Wx18"D Comfortuff Front/Rear Open Seat\* (DEFAULT CHOICE)  
(A-5"xB-8" opening, 2.5" waterfall foam)
- P60974 18"Wx18"D Comfortuff Contoured Front Open Seat  
(A-4"xB-6.5" opening, sloped foam)
- P60701 18"Wx18"D Ensolite® Front/Rear Open Seat\*  
(A-4.5"xB-7.75", 1" foam)
- P61058 18"Wx18"D Ensolite® Front Open Contoured Seat  
(A-5.5"xB-8.25" opening, 2" waterfall foam)
- P60675 18"Wx18"D Ensolite® Cloverleaf Seat  
(7.5"x9" oval opening, 1" foam)
- P60913 18"Wx18"D Ensolite® Front/Rear Open Seat\*  
(A-5.25"xB-8" opening, 2" waterfall foam)

\*Seat works in all 4 positions

Choose Frame Color  Black  White (if no selection is made, white will be selected)

#### PKG407 Package #3-18"Wx20"D-24" Solid Shallow Tread Wheels \$3,601

##### Package #3-18"Wx20"D Includes: (no substitutions)

18"Wx20"D Stainless Steel Frame, 24" Solid Shallow Tread Wheels, 5" Casters, Bolted Axles with Wheel Mounts and Anti-Tipping Levers, Wheel Locks, Seat, 20"D Left Hand Armrest with Pad, 20"D Right Hand Armrest with Pad, Left Gooseneck Leg Rest, Right Gooseneck Leg Rest, Left Foot Plate, Right Foot Plate, 18"W Solid Back, Waist Belt, and Pan/Hanger.

##### Seats- must select one

- P61121 18"Wx20"D Ensolite® Front/Rear Open Seat (DEFAULT CHOICE)  
(A-4.5"xB-7.5" opening, 1" foam)
- PP60903 18"Wx20"D Ensolite® Side Open Seat  
(A-4.5"xB-7.75" opening, 1" foam)

Choose Frame Color  Black  White (if no selection is made, white will be selected)

#### PKG408 Package #4-20"Wx18"D-24" Solid Shallow Tread Wheels \$3,656

##### Package #4-20"Wx18"D Includes: (no substitutions)

20"Wx18"D Stainless Steel Frame, 24" Solid Shallow Tread Wheels, 5" Casters, Bolted Axles with Wheel Mounts and Anti-Tipping Levers, Wheel Locks, 20"Wx18"D Ensolite® Front/Rear Seat, 18"D Left Hand Armrest with Pad, 18"D Right Hand Armrest with Pad, Left Gooseneck Leg Rest, Right Gooseneck Leg Rest, Left Foot Plate, Right Foot Plate, 20"W Solid Back, Waist Belt, and Pan/Hanger.

Choose Frame Color  Black  White (if no selection is made, white will be selected)

#### PKG409 Package #5-22"Wx18"D-24" Solid Shallow Tread Wheels \$4,148

##### Package #5-22"Wx18"D Includes: (no substitutions)

22"Wx18"D Stainless Steel Frame, 24" Solid Shallow Tread Wheels, 5" Casters, Bolted Axles with Wheel Mounts and Anti-Tipping Levers, Wheel Locks, 22"Wx18"D Ensolite® Front/Rear Seat, 18"D Left Hand Armrest with Pad, 18"D Right Hand Armrest with Pad, Left Gooseneck Leg Rest, Right Gooseneck Leg Rest, Left Foot Plate, Right Foot Plate, 22"W Solid Back, Waist Belt, and Pan/Hanger.

Choose Frame Color  Black  White (if no selection is made, white will be selected)

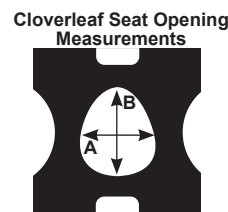
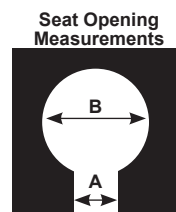

# 720 Bariatric Rehab Shower/Commode Chair

## Package-Order Form

600 lb. Weight Capacity  
Effective July 20, 2022

# ActiveAid

101 Activeaid Road  
Redwood Falls, MN 56283  
ph. 800.533.5330 fax 888.224.8622

### Bill To:

Date: \_\_\_\_\_  
P.O.#: \_\_\_\_\_  
Quote#: \_\_\_\_\_  
Account#: \_\_\_\_\_  
Ordered By: \_\_\_\_\_  
Supplier Company: \_\_\_\_\_  
Address: \_\_\_\_\_  
City, State, Zip: \_\_\_\_\_  
Phone: \_\_\_\_\_  
Email: \_\_\_\_\_

### Ship To:

Name: \_\_\_\_\_  
Address: \_\_\_\_\_  
City/State: \_\_\_\_\_  
Zip: \_\_\_\_\_  
Phone: \_\_\_\_\_  
Tag For: \_\_\_\_\_

**Email form to [orders@activeaid.com](mailto:orders@activeaid.com)  
Fax this form to 888.224.8622**

### Packages:

**PKG410 Package #1-20"W** \$4,432

**Package #1-20"W Includes: (no substitutions)**

20"Wx20"D Stainless Steel Frame, 20" Solid Shallow Tread Wheels, 6" Casters, Bolted Axles with Anti-Tipping Levers, Wheel Locks, Seat, Left Hand Armrest with Pad, Right Hand Armrest with Pad, 20"W 1-pc. Foot Plate/Leg Rest, 20"W Contoured Solid Back, Waist Belt, and Pan/Hanger.

**Seats- must select one**

- P60886** 20"Wx20"D Ensolite® Race Track Oval Seat (DEFAULT CHOICE)  
(A-7.75"xB-12.75" opening, 1.5" foam)
- P61117** 20"Wx20"D Ensolite® Front/Rear Open Seat  
(A-4.5"xB-7.75" opening, 1" foam)

**Choose Frame Color**    Black    White (if no selection is made, white will be selected)

**PKG411 Package #2-22"W** \$4,644

**Package #2-22"W Includes: (no substitutions)**

22"Wx20"D Stainless Steel Frame, 20" Solid Shallow Tread Wheels, 6" Casters, Bolted Axles with Anti-Tipping Levers, Wheel Locks, Seat, Left Hand Armrest with Pad, Right Hand Armrest with Pad, 22"W 1-pc. Foot Plate/Leg Rest, 22"W Solid Back, Waist Belt, and Pan/Hanger.

**Seats- must select one**

- P60887** 22"Wx20"D Ensolite® Race Track Oval Seat (DEFAULT CHOICE)  
(A-7.75"xB-12.75" opening, 1.5" foam)
- P61118** 22"Wx20"D Ensolite® Front/Rear Open Seat  
(A-4.5"xB-7.75" opening, 1" foam)

**Choose Frame Color**    Black    White (if no selection is made, white will be selected)

**PKG412 Package #3-24"W** \$4,831

**Package #3-24"W Includes: (no substitutions)**

24"Wx20"D Stainless Steel Frame, 20" Solid Shallow Tread Wheels, 6" Casters, Bolted Axles with Anti-Tipping Levers, Wheel Locks, Seat, Left Hand Armrest with Pad, Right Hand Armrest with Pad, 24"W 1-pc. Foot Plate/Leg Rest, 24"W Solid Back, Waist Belt, and Pan/Hanger.

**Seats- must select one**

- P60888** 24"Wx20"D Ensolite® Race Track Oval Seat (DEFAULT CHOICE)  
(A-7.75"xB-12.75" opening, 1.5" foam)
- P61119** 24"Wx20"D Ensolite® Front/Rear Open Seat  
(A-4.5"xB-7.75" opening, 1" foam)

**Choose Frame Color**    Black    White (if no selection is made, white will be selected)

**PKG413 Package #4-26"W** \$5,133

**Package #3-26"W Includes: (no substitutions)**

26"Wx20"D Stainless Steel Frame, 20" Solid Shallow Tread Wheels, 6" Casters, Bolted Axles with Anti-Tipping Levers, Wheel Locks, 26"Wx20"D Ensolite® Race Track Oval Seat, Left Hand Armrest with Pad, Right Hand Armrest with Pad, 26"W 1-pc. Foot Plate/Leg Rest, 26"W Solid Back, Waist Belt, and Pan/Hanger.

**Choose Frame Color**    Black    White (if no selection is made, white will be selected)

**PKG414 Package #5-28"W** \$5,413

**Package #4-28"W Includes: (no substitutions)**

28"Wx20"D Stainless Steel Frame, 20" Solid Shallow Tread Wheels, 6" Casters, Bolted Axles with Anti-Tipping Levers, Wheel Locks, 28"Wx20"D Ensolite® Race Track Oval Seat, Left Hand Armrest with Pad, Right Hand Armrest with Pad, 28"W 1-pc. Foot Plate/Leg Rest, 28"W Solid Back, and Pan/Hanger.

**Choose Frame Color**    Black    White (if no selection is made, white will be selected)

**PKG415 Package #6-30"W** \$5,863

**Package #6-30"W Includes: (no substitutions)**

30"Wx20"D Stainless Steel Frame, 20" Solid Shallow Tread Wheels, 6" Casters, Bolted Axles with Anti-Tipping Levers, Wheel Locks, 30"Wx20"D Ensolite® Race Track Oval Seat, Left Hand Armrest with Pad, Right Hand Armrest with Pad, 30"W 1-pc. Foot Plate/Leg Rest, 30"W Solid Back, and Pan/Hanger.

**Choose Frame Color**    Black    White (if no selection is made, white will be selected)

**Front/Rear Seat Opening Measurements**      **Race Track Seat Opening Measurements**

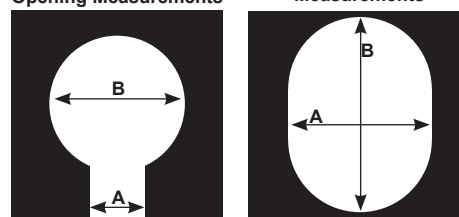

# 922 Rehab Shower/Commode Chair-Folding Package-Order Form

350 lb. Weight Capacity

Effective July 20, 2022

# ActiveAid

101 Activeaid Road  
Redwood Falls, MN 56283  
ph. 800.533.5330 fax 888.224.8622

## Bill To:

Date: \_\_\_\_\_  
P.O.#: \_\_\_\_\_  
Quote#: \_\_\_\_\_  
Account#: \_\_\_\_\_  
Ordered By: \_\_\_\_\_  
Supplier Company: \_\_\_\_\_  
Address: \_\_\_\_\_  
City, State, Zip: \_\_\_\_\_  
Phone: \_\_\_\_\_  
Email: \_\_\_\_\_

## Ship To:

Name: \_\_\_\_\_  
Address: \_\_\_\_\_  
City/State: \_\_\_\_\_  
Zip: \_\_\_\_\_  
Phone: \_\_\_\_\_  
Tag For: \_\_\_\_\_

**Email form to [orders@activeaid.com](mailto:orders@activeaid.com)  
Fax this form to 888.224.8622**

## Packages:

### PKG301 Package #1 \$3,555

**Package #1 Includes: (no substitutions)**

18"Wx18"D Stainless Steel Frame, 22" Solid Shallow Tread Wheels, 5" Casters. Bolted Axles, Wheel Locks, 18"Wx18"D Ensolite® Front Open Seat, Left Hand Height-Adjustable Armrest, Right Hand Height-Adjustable Armrest, Left Gooseneck Leg Rest, Right Gooseneck Leg Rest, Left Foot Plate, Right Foot Plate, 18"W Sling Back, Waist Belt, and Pan/Hanger.

**Choose Frame Color**    Black    White (if no selection is made, white will be selected)

### PKG302 Package #2 \$3,556

**Package #2 Includes: (no substitutions)**

18"Wx18"D Stainless Steel Frame, 24" Solid Shallow Tread Wheels, 5" Casters, Quick Release Axles, Wheel Locks, Seat, Left Hand Flip-Up Armrest, Right Hand Flip-Up Armrest, Left Gooseneck Leg Rest, Right Gooseneck Leg Rest, Left Foot Plate, Right Foot Plate, 18"W Sling Back, Waist Belt, and Pan/Hanger.

**Seats- must select one**

- P60993** 18"Wx18"D Comfortuff Front Open Seat  
(A-5"xB-8" opening, 2.5" waterfall foam)
- PP60974** 18"Wx18"D Comfortuff Contoured Front Open Seat  
(A-4"xB-6.5" opening, sloped foam)
- P61120** 18"Wx18"D Ensolite® Front Open (DEFAULT CHOICE)  
(A-3"xB-5.25", 2"dual density foam w/coccyx notch)
- PP61058** 18"Wx18"D Ensolite® Front Open Contoured Seat  
(A-5.5"xB-8.25" opening, 2" waterfall foam)
- P60675** 18"Wx18"D Ensolite® Cloverleaf Seat  
(7.5"x9" oval opening, 1" foam)
- PP60701** 18"Wx18"D Ensolite® Front/Rear Open Seat  
(A-4.5"xB-7.75", 1" foam)
- PP60850** 18"Wx18"D Ensolite® Front/Rear Open Seat  
(A-5"xB-8" opening, 1" waterfall foam)
- P60913** 18"Wx18"D Ensolite® Front/Rear Open Seat  
(A-5.25"xB-8" opening, 2" waterfall foam)

**Choose Frame Color**    Black    White (if no selection is made, white will be selected)

### PKG303 Package #3 \$5,315

**Package #3 Includes: (no substitutions)**

18"Wx18"D Stainless Steel Frame, 24" Solid Shallow Tread Wheels, 24" PVC Handrims, 5" Dual Locking Casters, Quick Release Axles, Wheel Locks with Extended Handle, Seat, Left Hand Height-Adjustable Armrest, Right Hand Height-Adjustable Armrest, Left Elevating Leg Rest, Right Elevating Leg Rest, Left Foot Plate with Heel Loop, Right Foot Plate with Heel Loop, 18"W Solid Back, Bodypoint® Trunk Belts, Waist Belt and Pan/Hanger.

**Seats- must select one**

- P60993** 18"Wx18"D Comfortuff Front Open Seat  
(A-5"xB-8" opening, 2.5" waterfall foam)
- PP60974** 18"Wx18"D Comfortuff Contoured Front Open Seat  
(A-4"xB-6.5" opening, sloped foam)
- P61120** 18"Wx18"D Ensolite® Front Open (DEFAULT CHOICE)  
(A-3"xB-5.25", 2"dual density foam w/coccyx notch)
- PP61058** 18"Wx18"D Ensolite® Front Open Contoured Seat  
(A-5.5"xB-8.25" opening, 2" waterfall foam)
- P60675** 18"Wx18"D Ensolite® Cloverleaf Seat  
(7.5"x9" oval opening, 1" foam)
- PP60701** 18"Wx18"D Ensolite® Front/Rear Open Seat  
(A-4.5"xB-7.75", 1" foam)
- PP60850** 18"Wx18"D Ensolite® Front/Rear Open Seat  
(A-5"xB-8" opening, 1" waterfall foam)
- P60913** 18"Wx18"D Ensolite® Front/Rear Open Seat  
(A-5.25"xB-8" opening, 2" waterfall foam)

**Choose Frame Color**    Black    White (if no selection is made, white will be selected)

**Front/Rear Open Seat  
Opening Measurements**

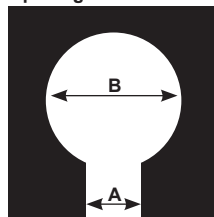

**Cloverleaf Seat Opening  
Measurements**

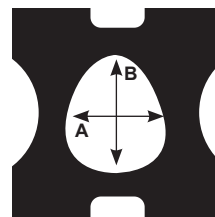

# 1100 Rehab Shower/Commode Chair-Seat Height/Slope Adjustable Package-Order Form

350 lb. Weight Capacity

Effective July 20, 2022

# ActiveAid

101 Activeaid Road  
Redwood Falls, MN 56283  
ph. 800.533.5330 fax 888.224.8622

## Bill To:

Date: \_\_\_\_\_  
P.O.#: \_\_\_\_\_  
Quote#: \_\_\_\_\_  
Account#: \_\_\_\_\_  
Ordered By: \_\_\_\_\_  
Supplier Company: \_\_\_\_\_  
Address: \_\_\_\_\_  
City, State, Zip: \_\_\_\_\_  
Phone: \_\_\_\_\_  
Email: \_\_\_\_\_

## Ship To:

Name: \_\_\_\_\_  
Address: \_\_\_\_\_  
City/State: \_\_\_\_\_  
Zip: \_\_\_\_\_  
Phone: \_\_\_\_\_  
Tag For: \_\_\_\_\_

Email form to [orders@activeaid.com](mailto:orders@activeaid.com)  
Fax this form to 888.224.8622

## Packages:

### PKG419 Package #1-18"Wx18"D-5"Casters Front and Rear \$3,198

#### Package #1-18"Wx18"D Includes: (no substitutions)

18"Wx18"D Stainless Steel Frame, 4-5" Dual Locking Casters, Seat, Left Hand Armrest with Pad, Right Hand Armrest with Pad, Left Leg Rest, Right Leg Rest, Left Foot Plate, Right Foot Plate, 18"W Solid Back, Waist Belt, and Pan/Hanger.

#### Seats- must select one

- P60993 18"Wx18"D Comfortuff Front/Rear Open Seat\* (DEFAULT CHOICE)  
(A-5"xB-8" opening, 2.5" waterfall foam)
- P60974 18"Wx18"D Comfortuff Contoured Front Open Seat  
(A-4"xB-6.5" opening, sloped foam)
- P60850 18"Wx18"D Ensolite® Front/Rear Open Seat\*  
(A-5"xB-8" opening, 1" waterfall foam)
- P60913 18"Wx18"D Ensolite® Front/Rear Open Seat\*  
(A-5.25"xB-8" opening, 2" waterfall foam)
- P61058 18"Wx18"D Ensolite® Front Open Contoured Seat  
(A-5.5"xB-8.25" opening, 2" waterfall foam)

\*Seat works in all 4 positions

Choose Frame Color  Black  White (if no selection is made, white will be selected)

### PKG420 Package #2-18"Wx18"D-24" Solid Shallow Tread Wheels \$4,091

#### Package #2-18"Wx18"D Includes: (no substitutions)

18"Wx18"D Stainless Steel Frame, 24" Solid Shallow Tread Wheels, 5" Dual Locking Casters, Quick Release Axles, Wheel Locks, Seat, Left Hand Armrest with Pad, Right Hand Armrest with Pad, Left Leg Rest, Right Leg Rest, Left Foot Plate, Right Foot Plate, 18"W Solid Back, Waist Belt, and Pan/Hanger.

#### Seats- must select one

- P60993 18"Wx18"D Comfortuff Front/Rear Open Seat\* (DEFAULT CHOICE)  
(A-5"xB-8" opening, 2.5" waterfall foam)
- P60974 18"Wx18"D Comfortuff Contoured Front Open Seat  
(A-4"xB-6.5" opening, sloped foam)
- P60850 18"Wx18"D Ensolite® Front/Rear Open Seat\*  
(A-5"xB-8" opening, 1" waterfall foam)
- P60913 18"Wx18"D Ensolite® Front/Rear Open Seat\*  
(A-5.25"xB-8" opening, 2" waterfall foam)
- P61058 18"Wx18"D Ensolite® Front Open Contoured Seat  
(A-5.5"xB-8.25" opening, 2" waterfall foam)

\*Seat works in all 4 positions

Choose Frame Color  Black  White (if no selection is made, white will be selected)

### PKG421 Package #3-20"Wx18"D-24" Solid Shallow Tread Wheels \$4,299

#### Package #3-20"Wx18"D Includes: (no substitutions)

20"Wx18"D Stainless Steel Frame, 24" Solid Shallow Tread Wheels, 5" Dual Locking Casters, Quick Release Axles, Wheel Locks, Seat, Left Hand Armrest with Pad, Right Hand Armrest with Pad, Left Leg Rest, Right Leg Rest, Left Foot Plate, Right Foot Plate, 20"W Solid Back, Waist Belt, and Pan/Hanger.

#### Seats- must select one

- P61038 20"Wx18"D Comfortuff Front Open Seat (DEFAULT CHOICE)  
(A-5"xB-8" opening, 1.5" waterfall foam)
- P60903 20"Wx18"D Ensolite® Front/Rear Seat  
(A-4.5"xB-7.75" opening, 1" foam)

Choose Frame Color  Black  White (if no selection is made, white will be selected)

### PKG422 Package #4--22"Wx18"D-24" Solid Shallow Tread Wheels \$4,689

#### Package #4-22"Wx18"D Includes: (no substitutions)

22"Wx18"D Stainless Steel Frame, 24" Solid Shallow Tread Wheels, 5" Dual Locking Casters, Quick Release Axles, Wheel Locks, 22"Wx18"D Ensolite® Front/Rear Seat, Left Hand Armrest with Pad, Right Hand Armrest with Pad, Left Leg Rest, Right Leg Rest, Left Foot Plate, Right Foot Plate, 22"W Solid Back, Waist Belt, and Pan/Hanger.

Choose Frame Color  Black  White (if no selection is made, white will be selected)

Seat Opening Measurements

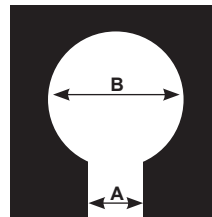



# 1218 Pediatric Rehab Shower/Commode Chair-Tilt

## Package-Order Form

250 lb. to 350 lb. Weight Capacity\*

Effective July 20, 2022

# ActiveAid

101 Activeaid Road  
Redwood Falls, MN 56283  
ph. 800.533.5330 fax 888.224.8622

### Bill To:

Date: \_\_\_\_\_  
P.O.#: \_\_\_\_\_  
Quote#: \_\_\_\_\_  
Account#: \_\_\_\_\_  
Ordered By: \_\_\_\_\_  
Supplier Company: \_\_\_\_\_  
Address: \_\_\_\_\_  
City, State, Zip: \_\_\_\_\_  
Phone: \_\_\_\_\_  
Email: \_\_\_\_\_

### Ship To:

Name: \_\_\_\_\_  
Address: \_\_\_\_\_  
City/State: \_\_\_\_\_  
Zip: \_\_\_\_\_  
Phone: \_\_\_\_\_  
Tag For: \_\_\_\_\_

Email form to [orders@activeaid.com](mailto:orders@activeaid.com)  
Fax this form to 888.224.8622

### Packages:

#### PKG214 Package #1-12"Wx12"D Seat \$5,179

##### Package #1-12"Wx12"D Includes: (no substitutions)

18"Wx18"D Stainless Steel Frame, 4-5" Dual Locking Casters, 12"Wx12"D Ensolite® Front/Rear Open Seat, Left Hand Armrest with Pad, Right Hand Armrest with Pad, Left Pediatric Leg Rest, Right Pediatric Leg Rest, Left Foot Plate, Right Foot Plate, 18"W Adjustable Sling Back, Waist Belt, Calf Strap, Left Hand Swing-Away Adjustable Lateral, Right Hand Swing-Away Adjustable Lateral, Left Hand Arm-Mounted Hip Guide, Right Hand Arm-Mounted Hip Guide, Pan/Hanger, and Head Support-Small.

Choose Frame Color  Black  White (if no selection is made, white will be selected)

#### PKG215 Package #2-14"Wx14"D Seat \$5,179

##### Package #2-14"Wx14"D Includes: (no substitutions)

18"Wx18"D Stainless Steel Frame, 4-5" Dual Locking Casters, 14"Wx14"D Ensolite® Front/Rear Open Seat, Left Hand Armrest with Pad, Right Hand Armrest with Pad, Left Pediatric Leg Rest, Right Pediatric Leg Rest, Left Foot Plate, Right Foot Plate, 18"W Adjustable Sling Back, Waist Belt, Calf Strap, Left Hand Swing-Away Adjustable Lateral, Right Hand Swing-Away Adjustable Lateral, Left Hand Arm-Mounted Hip Guide, Right Hand Arm-Mounted Hip Guide, Pan/Hanger, and Head Support-Small.

Choose Frame Color  Black  White (if no selection is made, white will be selected)

#### PKG216 Package #3-16"Wx16"D Seat \$ 4,608

##### Package #3-16"Wx16"D Includes: (no substitutions)

18"Wx18"D Stainless Steel Frame, 4-5" Dual Locking Casters, 16"Wx16"D Ensolite® Front/Rear Open Seat, Left Hand Armrest with Pad, Right Hand Armrest with Pad, Left Gooseneck Leg Rest, Right Gooseneck Leg Rest, Left Foot Plate, Right Foot Plate, 18"W Adjustable Sling Back, Waist Belt, Calf Strap, Left Hand Swing-Away Adjustable Lateral, Right Hand Swing-Away Adjustable Lateral, Pan/Hanger, and Head Support-Large.

Choose Frame Color  Black  White (if no selection is made, white will be selected)

#### PKG217 Package #4-18"Wx18"D Seat \$4,721

##### Package #4-18"Wx18"D Includes: (no substitutions)

18"Wx18"D Stainless Steel Frame, 4-5" Dual Locking Casters, 18"Wx18"D Ensolite® Front/Rear Open Seat, Left Hand Armrest with Pad, Right Hand Armrest with Pad, Left Gooseneck Leg Rest, Right Gooseneck Leg Rest, Left Foot Plate, Right Foot Plate, 18"W Adjustable Sling Back, Waist Belt, Calf Strap, Left Hand Swing-Away Adjustable Lateral, Right Hand Swing-Away Adjustable Lateral, Pan/Hanger, and Head Support-Large.

Choose Frame Color  Black  White (if no selection is made, white will be selected)

#### Seat Opening Measurements

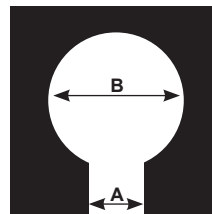

#### \* Weight Capacity for Seats

12"Wx12"D - 250lbs.

14"Wx14"D - 350lbs.

16"Wx16"D - 350lbs.

18"Wx18"D - 350lbs.