

# 202 Rehab Shower/Commode Chair-Bath/Toilet Modular System

## MSRP Itemized Price List/Order Form

350 lb. Weight Capacity

Effective August 1, 2019

# ActiveAid

101 Activeaid Road  
Redwood Falls, MN 56283  
ph. 800.533.5330 fax 888.224.8622

### Bill To:

Date: \_\_\_\_\_  
P.O.#: \_\_\_\_\_  
Quote#: \_\_\_\_\_  
Account#: \_\_\_\_\_  
Ordered By: \_\_\_\_\_  
Supplier Company: \_\_\_\_\_  
Address: \_\_\_\_\_  
City, State, Zip: \_\_\_\_\_  
Phone: \_\_\_\_\_  
Email: \_\_\_\_\_

### Ship To:

Name: \_\_\_\_\_  
Address: \_\_\_\_\_  
City/State: \_\_\_\_\_  
Zip: \_\_\_\_\_  
Phone: \_\_\_\_\_  
Tag For: \_\_\_\_\_

**Email form to [orders@activeaid.com](mailto:orders@activeaid.com)  
Fax this form to 888.224.8622**

### Frames - must select one

**P13641** 18"Wx18"D White Stainless Steel Frame \$125

### Legs - must select one

**P13642** Legs w/Crutch Tips (height seat range from floor to bottom frame-16"-19") \$85  
 **P13643** Legs w/Suction Cups (height seat range from floor to bottom frame-16"-19") \$155

### Seats - must select one

**P60993** 18"Wx18"D Comfortuff Front/Rear Open Seat (A-5"xB-8" opening, 1.5" waterfall foam)\* \$350  
 **P60913** 18"Wx18"D Ensolite® Front/Rear Open Seat (A-5.25"xB-8" opening, 2" waterfall foam)\* \$340  
 **P61086** 18"Wx18"D Ensolite® Solid Seat (2" foam) \$330  
 **P61058** 18"Wx18"D Ensolite® Front Open Seat (A-5.5"xB-8.25" opening, 2" waterfall/contoured foam) \$350  
 **P60850** 18"Wx18"D Ensolite® Front/Rear Open Seat (A-5"xB-8" opening, 1" waterfall foam)\* \$310  
\*Seat works in all 4 positions

**Seat Opening Measurements**

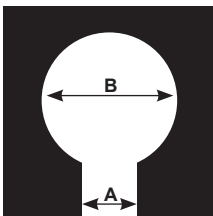

### Backs

**P13295** Back Tubes w/Solid Back Pad (13.25"H) \$325

### Armrests

**PL13291** Left Hand Armrest with Pad \$105  
 **PR13291** Right Hand Armrest with Pad \$105

### Belts - back required

**PW60884** Waist Belt (64" circumference with 12" overlap) \$60  
 **PT60909** Trunk Belt (54" circumference with 12" overlap) \$60

### Benches

**P13294** B-O Transfer Bench \$300  
 **P13352** Short Transfer Bench \$300

### Pans

**P13825** 18"Wx18"D Pan/Hanger \$110

### Notes

---

---

---

---

---

---

---

---

---

---