

285 Rehab Shower/Commode Chair-Tilt Package-Order Form

350 lb. Weight Capacity

Effective January 1, 2024

ActiveAid

101 Activeaid Road
Redwood Falls, MN 56283
ph. 800.533.5330 fax 888.224.8622

Bill To:

Date: _____
P.O.#: _____
Quote#: _____
Account#: _____
Ordered By: _____
Supplier Company: _____
Address: _____
City, State, Zip: _____
Phone: _____
Email: _____

Ship To:

Name: _____
Address: _____
City/State: _____
Zip: _____
Phone: _____
Tag For: _____

Email form to orders@activeaid.com
Fax this form to 888.224.8622

Packages:

PKG203 Package #1-16"Wx18"D \$3,959

Package #1-16"Wx18"D Includes: (no substitutions)

16"Wx18"D Stainless Steel Frame, 4-5" Dual Locking Casters, 16"Wx18"D Ensolite® Front/Rear Open Seat, Left Hand Armrest with Pad, Right Hand Armrest with Pad, Left Gooseneck Leg Rest, Right Gooseneck Leg Rest, Left Foot Plate with Heel Loop, Right Foot Plate with Heel Loop, 16"W Adjustable Sling Back, Waist Belt, Calf Strap, Bodypoint® Trunk Belt, Pan/Hanger, Head Support-Large.

Choose Frame Color Black White (if no selection is made, white will be selected)

PKG204 Package #2-18"Wx18"D \$4,224

Package #2-18"Wx18"D Includes: (no substitutions)

18"Wx18"D Stainless Steel Frame, 4-5" Dual Locking Casters, Seat, Left Hand Armrest with Pad, Right Hand Armrest with Pad, Left Gooseneck Leg Rest, Right Goosneck Leg Rest, Left Foot Plate with Heel Loop, Right Foot Plate with Heel Loop, 18"W Adjustable Sling Back, Waist Belt, Calf Strap, Bodypoint® Trunk Belt, Pan/Hanger, Head Support-Large.

Seats- must select one

- P60993 18"Wx18"D Comfortuff Front/Rear Open Seat (DEFAULT CHOICE)
(A-5"xB-8" opening, 2.5" waterfall foam)
- P60974 18"Wx18"D Comfortuff Contoured Front Open Seat
(A-4"xB-6.5" opening, sloped foam)
- P60802 18"Wx18"D Ensolite® Front Open Ring Seat
(A-4.5"xB-7.75" opening, 1.25" foam)

Choose Frame Color Black White (if no selection is made, white will be selected)

PKG205 Package #3-20"Wx18"D \$4,838

Package #3-20"Wx18"D Includes: (no substitutions)

20"Wx18"D Stainless Steel Frame, 4-5" Dual Locking Casters, Seat, Left Hand Armrest with Pad, Right Hand Armrest with Pad, Left Gooseneck Leg Rest, Right Goosneck Leg Rest, Left Foot Plate with Heel Loop, Right Foot Plate with Heel Loop, 20"W Adjustable Sling Back, Waist Belt, Calf Strap, Bodypoint® Trunk Belt, Pan/Hanger, Head Support-Large.

Seats- must select one

- P61038 20"Wx18"D Comfortuff Front Open Seat (DEFAULT CHOICE)
(A-5"xB-8" opening, 1.5" waterfall foam)
- P60903 20"Wx18"D Ensolite® Front/Rear Open Seat
(A-4.5"xB-7.75" opening, 1" foam)

Choose Frame Color Black White (if no selection is made, white will be selected)

PKG206 Package #4-22"Wx18"D \$5,166

Package #4-22"Wx18"D Includes: (no substitutions)

22"Wx18"D Stainless Steel Frame, 4-5" Dual Locking Casters, Seat, Left Hand Armrest with Pad, Right Hand Armrest with Pad, Left Gooseneck Leg Rest, Right Goosneck Leg Rest, Left Foot Plate with Heel Loop, Right Foot Plate with Heel Loop, 22"W Adjustable Sling Back, Waist Belt, Calf Strap, Bodypoint® Trunk Belt, Pan/Hanger, Head Support-Large.

Choose Frame Color Black White (if no selection is made, white will be selected)

PKG207 Package #5-18"Wx18"D \$4,987

Package #5-18"Wx18"D Includes: (no substitutions)

18"Wx18"D Stainless Steel Frame, 24" Solid Shallow Tread Wheels, Bolted Axles with Anti-Tipping Lever, Wheel Locks, 5" Dual Locking Casters, Seat, Left Hand Armrest with Arm Trough, Right Hand Armrest with Arm Trough, Left Gooseneck Leg Rest, Right Goosneck Leg Rest, Left Foot Plate with Heel Loop, Right Foot Plate with Heel Loop, 18"W Adjustable Sling Back, Waist Belt, Calf Strap, Bodypoint® Trunk Belt, Pan/Hanger, Head Support-Large.

Seats- must select one

- P60993 18"Wx18"D Comfortuff Front/Rear Open Seat (DEFAULT CHOICE)
(A-5"xB-8" opening, 2.5" waterfall foam)
- P60974 18"Wx18"D Comfortuff Contoured Front Open Seat
(A-4"xB-6.5" opening, sloped foam)
- P60802 18"Wx18"D Ensolite® Front Open Ring Seat
(A-4.5"xB-7.75" opening, 1.25" foam)

Choose Frame Color Black White (if no selection is made, white will be selected)

PKG208 Package #6-18"Wx18"D \$5,973

Package #6-18"Wx18"D Includes: (no substitutions)

18"Wx18"D Stainless Steel Frame, 4-5" Dual Locking Casters, Seat, Left Hand Armrest with Arm Trough, Right Hand Armrest with Arm Trough, Left Elevating Leg Rest, Right Elevating Leg Rest, Left Foot Plate with Heel Loop, Right Foot Plate with Heel Loop, 18"W Adjustable Sling Back, Waist Belt, Bodypoint® Trunk Belt, Left Hand Swing-Away Adjustable Lateral, Right Hand Swing-Away Adjustable Lateral Pan/Hanger, Head Support-Large.

Seats- must select one

- P60993 18"Wx18"D Comfortuff Front/Rear Open Seat (DEFAULT CHOICE)
(A-5"xB-8" opening, 2.5" waterfall foam)
- P60974 18"Wx18"D Comfortuff Contoured Front Open Seat
(A-4"xB-6.5" opening, sloped foam)
- P60802 18"Wx18"D Ensolite® Front Open Ring Seat
(A-4.5"xB-7.75" opening, 1.25" foam)

Choose Frame Color Black White (if no selection is made, white will be selected)

Front Open Seat
Opening Measurements

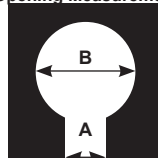

Race Track Oval
Opening Measurements

