

285 Rehab Shower/Commode Chair-Tilt

Package-Order Form

350 lb. Weight Capacity
Effective January 1, 2026

Email form to webquotes@altimatemedical.com

Bill To:

Date: _____
P.O.#: _____
Quote#: _____
Account#: _____
Ordered By: _____
Supplier Company: _____
ATP (REQUIRED): _____
Address: _____
City, State, Zip: _____
Phone: _____
Email: _____

Ship To:

Name: _____
Address: _____
City/State: _____
Zip: _____
Phone: _____
Tag For: _____



AltimateMedical
creating products · changing lives

Ph: 800.342.8968 or 507.697.6393

Fax: 877.342.8968 or 507.697.6900

webquotes@altimatemedical.com activeaid.com

Packages:

☐ **PKG204 Package #2-18"Wx18"D** \$4,569

Package #2-18"Wx18"D Includes: (no substitutions)

18"Wx18"D Stainless Steel Frame, 4-5" Dual Locking Casters, Seat, Left Hand Armrest with Pad, Right Hand Armrest with Pad, Left Gooseneck Leg Rest, Right Gooseneck Leg Rest, Left Foot Plate with Heel Loop, Right Foot Plate with Heel Loop, 18"W Adjustable Sling Back, Waist Belt, Calf Strap, Bodypoint® Trunk Belt, Pan/Hanger, Head Support-Large.

Seats- must select one

- ☐ **P60993** 18"Wx18"D Comfortuff Front/Rear Open Seat (DEFAULT CHOICE)
(A-5"xB-8" opening, 2.5" waterfall foam)
☐ **P60802** 18"Wx18"D Ensolite® Front Open Ring Seat
(A-4.5"xB-7.75" opening, 1.25" foam)

Choose Frame Color ☐ Black ☐ White (if no selection is made, white will be selected)

☐ **PKG207 Package #5-18"Wx18"D** \$5,395

Package #5-18"Wx18"D Includes: (no substitutions)

18"Wx18"D Stainless Steel Frame, 24" Solid Shallow Tread Wheels, Bolted Axles with Anti-Tipping Lever, Wheel Locks, 5" Dual Locking Casters, Seat, Left Hand Armrest with Arm Trough, Right Hand Armrest with Arm Trough, Left Gooseneck Leg Rest, Right Gooseneck Leg Rest, Left Foot Plate with Heel Loop, Right Foot Plate with Heel Loop, 18"W Adjustable Sling Back, Waist Belt, Calf Strap, Bodypoint® Trunk Belt, Pan/Hanger, Head Support-Large.

Seats- must select one

- ☐ **P60993** 18"Wx18"D Comfortuff Front/Rear Open Seat (DEFAULT CHOICE)
(A-5"xB-8" opening, 2.5" waterfall foam)
☐ **P60802** 18"Wx18"D Ensolite® Front Open Ring Seat
(A-4.5"xB-7.75" opening, 1.25" foam)

Choose Frame Color ☐ Black ☐ White (if no selection is made, white will be selected)

☐ **PKG208 Package #6-18"Wx18"D** \$6,461

Package #6-18"Wx18"D Includes: (no substitutions)

18"Wx18"D Stainless Steel Frame, 4-5" Dual Locking Casters, Seat, Left Hand Armrest with Arm Trough, Right Hand Armrest with Arm Trough, Left Elevating Leg Rest, Right Elevating Leg Rest, Left Foot Plate with Heel Loop, Right Foot Plate with Heel Loop, 18"W Adjustable Sling Back, Waist Belt, Bodypoint® Trunk Belt, Left Hand Swing-Away Adjustable Lateral, Right Hand Swing-Away Adjustable Lateral Pan/Hanger, Head Support-Large.

Seats- must select one

- ☐ **P60993** 18"Wx18"D Comfortuff Front/Rear Open Seat (DEFAULT CHOICE)
(A-5"xB-8" opening, 2.5" waterfall foam)
☐ **P60802** 18"Wx18"D Ensolite® Front Open Ring Seat
(A-4.5"xB-7.75" opening, 1.25" foam)

Choose Frame Color ☐ Black ☐ White (if no selection is made, white will be selected)

**Front Open Seat
Opening Measurements**

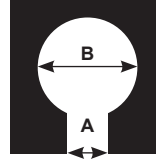

**Race Track Oval
Opening Measurements**

