

# 285 Rehab Shower/Commode Chair-Tilt Package-Price List/Order Form

350 lb. Weight Capacity

Effective May 1, 2019

# ActiveAid

101 Activeaid Road  
Redwood Falls, MN 56283  
ph. 800.533.5330 fax 888.224.8622

## Bill To:

Date: \_\_\_\_\_  
P.O.#: \_\_\_\_\_  
Quote#: \_\_\_\_\_  
Account#: \_\_\_\_\_  
Ordered By: \_\_\_\_\_  
Supplier Company: \_\_\_\_\_  
Address: \_\_\_\_\_  
City, State, Zip: \_\_\_\_\_  
Phone: \_\_\_\_\_  
Email: \_\_\_\_\_

## Ship To:

Name: \_\_\_\_\_  
Address: \_\_\_\_\_  
City/State: \_\_\_\_\_  
Zip: \_\_\_\_\_  
Phone: \_\_\_\_\_  
Tag For: \_\_\_\_\_

**Email form to [orders@activeaid.com](mailto:orders@activeaid.com)  
Fax this form to 888.224.8622**

## Packages:

### PKG203 Package #1-16"Wx18"D \$3,629

**Package #1-16"Wx18"D Includes: (no substitutions)**

16"Wx18"D Stainless Steel Frame, 4-5" Dual Locking Casters, 16"Wx18"D Ensolite® Front/Rear Open Seat, Left Hand Armrest with Pad, Right Hand Armrest with Pad, Left Gooseneck Leg Rest, Right Gooseneck Leg Rest, Left Foot Plate with Heel Loop, Right Foot Plate with Heel Loop, 16"W Adjustable Sling Back, Waist Belt, Calf Strap, Bodypoint® Trunk Belt, Pan/Hanger, Head Support-Large.

**Choose Frame Color**    Black    White (if no selection is made, white will be selected)

### PKG204 Package #2-18"Wx18"D \$3,719

**Package #2-18"Wx18"D Includes: (no substitutions)**

18"Wx18"D Stainless Steel Frame, 4-5" Dual Locking Casters, Seat, Left Hand Armrest with Pad, Right Hand Armrest with Pad, Left Gooseneck Leg Rest, Right Goosneck Leg Rest, Left Foot Plate with Heel Loop, Right Foot Plate with Heel Loop, 18"W Adjustable Sling Back, Waist Belt, Calf Strap, Bodypoint® Trunk Belt, Pan/Hanger, Head Support-Large.

**Seats- must select one**

- P60993** 18"Wx18"D Comfortuff Front/Rear Open Seat (DEFAULT CHOICE)  
(A-5"xB-8" opening, 1.5" waterfall foam)
- P60974** 18"Wx18"D Comfortuff Contoured Front Open Seat  
(A-4"xB-6.5" opening, sloped foam)
- P60802** 18"Wx18"D Ensolite® Front Open Ring Seat  
(A-4.5"xB-7.75" opening, 1.25" foam)

**Choose Frame Color**    Black    White (if no selection is made, white will be selected)

### PKG205 Package #3-20"Wx18"D \$4,224

**Package #3-20"Wx18"D Includes: (no substitutions)**

20"Wx18"D Stainless Steel Frame, 4-5" Dual Locking Casters, Seat, Left Hand Armrest with Pad, Right Hand Armrest with Pad, Left Gooseneck Leg Rest, Right Goosneck Leg Rest, Left Foot Plate with Heel Loop, Right Foot Plate with Heel Loop, 20"W Adjustable Sling Back, Waist Belt, Calf Strap, Bodypoint® Trunk Belt, Pan/Hanger, Head Support-Large.

**Seats- must select one**

- P61038** 20"Wx18"D Comfortuff Front Open Seat (DEFAULT CHOICE)  
(A-5"xB-8" opening, 1.5" waterfall foam)
- P60903** 20"Wx18"D Ensolite® Front/Rear Open Seat  
(A-4.5"xB-7.75" opening, 1" foam)

**Choose Frame Color**    Black    White (if no selection is made, white will be selected)

### PKG206 Package #4-22"Wx18"D \$4,534

**Package #4-22"Wx18"D Includes: (no substitutions)**

22"Wx18"D Stainless Steel Frame, 4-5" Dual Locking Casters, Seat, Left Hand Armrest with Pad, Right Hand Armrest with Pad, Left Gooseneck Leg Rest, Right Goosneck Leg Rest, Left Foot Plate with Heel Loop, Right Foot Plate with Heel Loop, 22"W Adjustable Sling Back, Waist Belt, Calf Strap, Bodypoint® Trunk Belt, Pan/Hanger, Head Support-Large.

**Choose Frame Color**    Black    White (if no selection is made, white will be selected)

### PKG207 Package #5-18"Wx18"D \$4,319

**Package #5-18"Wx18"D Includes: (no substitutions)**

18"Wx18"D Stainless Steel Frame, 24" Wheels, Bolted Axles with Tipping Lever, Wheel Locks, 5" Dual Locking Casters, Seat, Left Hand Armrest with Arm Trough, Right Hand Armrest with Arm Trough, Left Gooseneck Leg Rest, Right Goosneck Leg Rest, Left Foot Plate with Heel Loop, Right Foot Plate with Heel Loop, 18"W Adjustable Sling Back, Waist Belt, Calf Strap, Bodypoint® Trunk Belt, Pan/Hanger, Head Support-Large.

**Seats- must select one**

- P60993** 18"Wx18"D Comfortuff Front/Rear Open Seat (DEFAULT CHOICE)  
(A-5"xB-8" opening, 1.5" waterfall foam)
- P60974** 18"Wx18"D Comfortuff Contoured Front Open Seat  
(A-4"xB-6.5" opening, sloped foam)
- P60802** 18"Wx18"D Ensolite® Front Open Ring Seat  
(A-4.5"xB-7.75" opening, 1.25" foam)

**Choose Frame Color**    Black    White (if no selection is made, white will be selected)

### PKG208 Package #6-18"Wx18"D \$5,349

**Package #6-18"Wx18"D Includes: (no substitutions)**

18"Wx18"D Stainless Steel Frame, 4-5" Dual Locking Casters, Seat, Left Hand Armrest with Arm Trough, Right Hand Armrest with Arm Trough, Left Elevating Leg Rest, Right Elevating Leg Rest, Left Foot Plate with Heel Loop, Right Foot Plate with Heel Loop, 18"W Adjustable Sling Back, Waist Belt, Bodypoint® Trunk Belt, Left Hand Swing-Away Adjustable Lateral, Right Hand Swing-Away Adjustable Lateral Pan/Hanger, Head Support-Large.

**Seats- must select one**

- P60993** 18"Wx18"D Comfortuff Front/Rear Open Seat (DEFAULT CHOICE)  
(A-5"xB-8" opening, 1.5" waterfall foam)
- P60974** 18"Wx18"D Comfortuff Contoured Front Open Seat  
(A-4"xB-6.5" opening, sloped foam)
- P60802** 18"Wx18"D Ensolite® Front Open Ring Seat  
(A-4.5"xB-7.75" opening, 1.25" foam)

**Choose Frame Color**    Black    White (if no selection is made, white will be selected)

**Front Open Seat  
Opening Measurements**

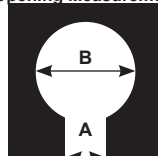

**Race Track Oval  
Opening Measurements**

