

285 Rehab Shower/Commode Chair-Tilt

350 lb. Weight Capacity

Effective January 1, 2026

Bill To:

Date:_____

P.O.#:_____

Quote#:_____

Account#:_____

Ordered By:_____

Supplier Company:_____

ATP (REQUIRED):_____

Address:_____

City, State, Zip:_____

Phone:_____

Email:_____

Frames - frame, seat and back must match same widths, must select one

Choose Frame Color

☐ Black ☐ White (if no selection is made, white will be selected)

<input type="checkbox"/> P13636	18"Wx18"D Stainless Steel Frame	\$1,941
<input type="checkbox"/> SPECIAL SIZE	16"Wx18"D Stainless Steel Frame	INQUIRE FOR PRICING
<input type="checkbox"/> SPECIAL SIZE	20"Wx18"D Stainless Steel Frame	INQUIRE FOR PRICING
<input type="checkbox"/> SPECIAL SIZE	22"Wx18"D Stainless Steel Frame	INQUIRE FOR PRICING

Wheels/Rear Casters - must select one wheel or caster option

<input type="checkbox"/> P60800-2	5" Dual Locking Casters (pair)	\$159
<input type="checkbox"/> P13862	24" Solid Shallow Tread Wheels (pair)	\$530
<input type="checkbox"/> P13864	24" Pneumatic Deep Tread Wheels (pair)	\$530
<input type="checkbox"/> P13865	24" Pneumatic Flat Free Deep Tread Wheels (pair)	\$530
<input type="checkbox"/> P13857	24" PVC Handrims (replaces standard handrims, pair)	\$312

Axles - must select one if 24" wheels were selected

<input type="checkbox"/> P13688	Bolted Axles with Anti-Tipping Levers (pair)	\$61
--	--	------

Wheel Locks - must select one if wheels were selected

<input type="checkbox"/> P13975	Wheel Locks (pair)	\$125
<input type="checkbox"/> P13976	Wheel Locks with Extended Handle (pair)	\$166

Front Casters - must select one

<input type="checkbox"/> P60841-2	5" Casters (pair)	\$136
<input type="checkbox"/> P60800-2	5" Dual Locking Casters (pair)	\$159

Seats - frame, seat and back must match same widths, must select one

<input type="checkbox"/> P61189	18"Wx18"D Molded Gel Front Open Contoured Seat (A-3.5"xB-7.25" opening, 2.5" gel)	\$591
<input type="checkbox"/> P61190	18"Wx18"D Molded Foam Oval Contoured Seat (A-7.25"xB-12.5" opening, 2.25" foam)	\$507
<input type="checkbox"/> P61191	18"Wx18"D Molded Gel Oval Contoured Seat (A-7.25"xB-12.5" opening, 2.5" gel)	\$591
<input type="checkbox"/> P61192	18"Wx18"D Molded Foam Front Open Contoured Seat (A-3.5"xB-7.25" opening, 2.25" foam)	\$507
<input type="checkbox"/> P61124	16"Wx18"D Ensolite® Front/Rear Open Seat (A-4.75"xB-7.75" opening, 1" foam)	\$530
<input type="checkbox"/> P60993	18"Wx18"D Comfortuff Front/Rear Open Seat (A-5"xB-8" opening, 2.5" waterfall foam)	\$440
<input type="checkbox"/> P61058	18"Wx18"D Ensolite® Front Open Contoured Seat (A-5.5"xB-8.25" opening, 2" waterfall foam)	\$497
<input type="checkbox"/> P60802	18"Wx18"D Ensolite® Front Open Ring Seat (A-4.5"xB-7.75" opening, 1.25" foam)	\$440
<input type="checkbox"/> P61086	18"Wx18"D Ensolite® Solid Seat (2" foam)	\$497
<input type="checkbox"/> P61121	18"Wx20"D Ensolite® Front Open Seat (A-4.5"xB-7.5" opening, 1" foam)	\$670
<input type="checkbox"/> P61038	20"Wx18"D Comfortuff Front Open Seat (A-5"xB-8" opening, 1.5" waterfall foam)	\$670
<input type="checkbox"/> P60903	20"Wx18"D Ensolite® Front/Rear Open Seat (A-4.5"xB-7.75" opening, 1" foam)	\$670
<input type="checkbox"/> PP61122	20"Wx18"D Ensolite® Solid Seat (1" foam)	\$670
<input type="checkbox"/> P60886	20"Wx20"D Ensolite® Race Track Oval Seat (A-7.75"xB-12.75" opening, 1.5" foam)	\$721
<input type="checkbox"/> P61123	20"Wx20"D Ensolite® Front/Rear Open Seat (A-4.5"xB-7.75" opening, 1" waterfall foam)	\$721
<input type="checkbox"/> P60905	22"Wx18"D Ensolite® Front Open Seat (A-4.5"xB-7.75" opening, 1" foam)	\$761
<input type="checkbox"/> P60887	22"Wx20"D Ensolite® Race Track Oval Seat (A-7.75"xB-12.75" opening, 1.5" foam)	\$789
<input type="checkbox"/> P61126	22"Wx20"D Ensolite® Front/Rear Open Seat (A-4.5"xB-7.75" opening, 1" foam)	\$811

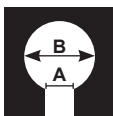
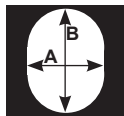
Front Open
Seat Opening
Measurements

Race Track Oval Seat
Opening Measurements

Armrests - must select right and left armrest

<input type="checkbox"/> P13611	Left Hand Armrest with Pad	\$181
<input type="checkbox"/> P13612	Right Hand Armrest with Pad	\$181
<input type="checkbox"/> P13613	Left Hand Armrest with Arm Trough	\$317
<input type="checkbox"/> P13614	Right Hand Armrest with Arm Trough	\$317
<input type="checkbox"/> P13615	Left Hand Height-Adjustable Armrest	\$345
<input type="checkbox"/> P13616	Right Hand Height-Adjustable Armrest	\$345

ActiveAid products should only be used under the guidance of a physician and or therapist. ActiveAid maintains a policy of continual product improvement and reserves the right to change features, specifications, and prices without prior notification. Check with ActiveAid for latest information. FORM 285PL 103025 Copyright © 2026 ActiveAid, Inc. All rights reserved. U.S. & international patents pending. Printed in the U.S.A.

Email form to webquotes@altimatemedical.com

Ship To:

Name:_____

Address:_____

City/State:_____

Zip:_____

Phone:_____

Tag For:_____



AltimateMedical

creating products · changing lives

Ph: 800.342.8968 or 507.697.6393

Fax: 877.342.8968 or 507.697.6900

webquotes@altimatemedical.com activeaid.com

Leg Rests - foot plate not included

<input type="checkbox"/> PL13581	Left Gooseneck Leg Rest	\$165
<input type="checkbox"/> PR13581	Right Gooseneck Leg Rest	\$165
<input type="checkbox"/> P13582	Left Elevating Leg Rest	\$634
<input type="checkbox"/> P13583	Right Elevating Leg Rest	\$634

Foot Plates

<input type="checkbox"/> PL11099	Left Foot Plate	\$24
<input type="checkbox"/> PR11099	Right Foot Plate	\$24
<input type="checkbox"/> PL11100	Left Foot Plate with Heel Loop	\$38
<input type="checkbox"/> PR11100	Right Foot Plate with Heel Loop	\$38
<input type="checkbox"/> P13891	Left Oversized Aluminum Foot Plate	\$189
<input type="checkbox"/> P13892	Right Oversized Aluminum Foot Plate	\$189
<input type="checkbox"/> PL11101	Left Padded Foot Plate	\$90
<input type="checkbox"/> PR11101	Right Padded Foot Plate	\$90

Backs - frame, seat and back must match same widths, must select one

<input type="checkbox"/> P61139	16"W Adjustable Sling Back	\$166
<input type="checkbox"/> P11110	16"W Solid Back	\$644
<input type="checkbox"/> P60877	18"W Adjustable Sling Back	\$177
<input type="checkbox"/> P11107	18"W Solid Back	\$658
<input type="checkbox"/> P60878	20"W Adjustable Sling Back	\$189
<input type="checkbox"/> P11108	20"W Solid Back	\$682
<input type="checkbox"/> P61140	22"W Adjustable Sling Back	\$201
<input type="checkbox"/> P11109	22"W Solid Back	\$716

Belts

<input type="checkbox"/> PW60884	Waist Belt (62", 64", 66" or 68" circumference with 12" overlap)	\$80
<input type="checkbox"/> PT61180	Trunk Belt	\$80
<input type="checkbox"/> P60879	Calf Strap (not available with P13582 and P13583 elevating leg rests)	\$80
<input type="checkbox"/> P11093	Bodypoint® Trunk Belt	\$243
<input type="checkbox"/> P11102	Bodypoint® Trunk Belt (pair)	\$458
<input type="checkbox"/> P11116	Bodypoint® Trunk Belt & Waist Belt	\$301
<input type="checkbox"/> P11112	Bodypoint® XL Trunk Belt	\$254
<input type="checkbox"/> P11113	Bodypoint® Belt w/Quick Release Knobs	\$282
<input type="checkbox"/> P61169	Bodypoint® Calf Strap (only available with 16"W frame, not available with P13582 and P13583 elevating leg rests)	\$159
<input type="checkbox"/> P61170	Bodypoint® Calf Strap (only available with 20"W frame, not available with P13582 and P13583 elevating leg rests)	\$159
<input type="checkbox"/> P61081	Bodypoint® Calf Strap (only available with 18"W back, not available with P13582 and P13583 elevating leg rests)	\$159
<input type="checkbox"/> P11114	Bodypoint® Knee Belt	\$260

Positioning Aids

<input type="checkbox"/> PL13574	Left Hand Swing-Away Adjustable Lateral	\$382
<input type="checkbox"/> PR13574	Right Hand Swing-Away Adjustable Lateral	\$382
<input type="checkbox"/> PL13618	Left Hand Arm-Mounted Hip Guide (not available with P13615 Armrests)	\$364
<input type="checkbox"/> PR13618	Right Hand Arm-Mounted Hip Guide (not available with P13616 Armrests)	\$364
<input type="checkbox"/> P61006	Abductor/Deflector-Large	\$242

Pans

<input type="checkbox"/> P13831	Pan/Hanger for Ring and Contoured Seats	\$142
<input type="checkbox"/> P13832	Pan/Hanger for Front, Front/Rear, & Race Track Oval Seats	\$142

Head Supports

<input type="checkbox"/> P13900	Head Support-Large	\$418
<input type="checkbox"/> P13913	Head Support-XL	\$546