

285TR Rehab Shower/Commode Chair-Tilt, Recline, Seat Height Adjustment

MSRP Itemized Order Form

350 lb. Weight Capacity

Effective January 1, 2024



101 Activeaid Road
Redwood Falls, MN 56283
ph. 800.533.5330 fax 888.224.8622

Bill To:

Date: _____
P.O.#: _____
Quote#: _____
Account#: _____
Ordered By: _____
Supplier Company: _____
Address: _____
City, State, Zip: _____
Phone: _____
Email: _____

Choose Frame Color Black White (if no selection is made, white will be selected)

Frames - frame, seat, back and pan must match same widths and depths, must select one

<input type="checkbox"/> P13762	16"Wx18"D Stainless Steel Frame (height adjustable)	\$1,456
<input type="checkbox"/> P13763	18"Wx18"D Stainless Steel Frame (height adjustable)	\$1,508
<input type="checkbox"/> P13764	18"Wx20"D Stainless Steel Frame (height adjustable)	\$1,794
<input type="checkbox"/> P13765	20"Wx18"D Stainless Steel Frame (height adjustable)	\$2,392
<input type="checkbox"/> P13766	20"Wx20"D Stainless Steel Frame (height adjustable)	\$2,652
<input type="checkbox"/> P13767	22"Wx18"D Stainless Steel Frame (height adjustable)	\$3,137
<input type="checkbox"/> P13768	22"Wx20"D Stainless Steel Frame (height adjustable)	\$3,678

Frame Positioning- must select one

<input type="checkbox"/> P13759	Tilt	\$510
<input type="checkbox"/> P13760	Recline	\$510
<input type="checkbox"/> P13761	Tilt/Recline	\$1,030

Casters - must select one

<input type="checkbox"/> P60800-4	5" Dual Locking Casters (2 pair)	\$271
<input type="checkbox"/> P13770	5" Casters (pair) and 5" Dual Locking Casters (pair)	\$250

Seats - frame, seat, back and pan must match same widths and depths, must select one

<input type="checkbox"/> P61189	18"Wx18"D Molded Gel Front Open Contoured Seat (A-3.5"xB-7.25" opening, 2.5" gel)	\$546
<input type="checkbox"/> P61190	18"Wx18"D Molded Foam Oval Contoured Seat (A-7.25"xB-12.5" opening, 2.25" foam)	\$468
<input type="checkbox"/> P61191	18"Wx18"D Molded Gel Oval Contoured Seat (A-7.25"xB-12.5" opening, 2.5" gel)	\$546
<input type="checkbox"/> P61192	18"Wx18"D Molded Foam Front Open Contoured Seat (A-3.5"xB-7.25" opening, 2.25" foam)	\$468
<input type="checkbox"/> P61124	16"Wx18"D Ensolite® Front Open Seat (A-4.75"xB-7.75" opening, 1" foam)	\$489
<input type="checkbox"/> P60913	18"Wx18"D Ensolite® Front/Rear Open Seat (A-5.25"xB-8" opening, 2" waterfall foam)	\$458
<input type="checkbox"/> P60993	18"Wx18"D Comfortuff Front/Rear Open Seat (A-5"xB-8D opening, 2.5" waterfall foam)*	\$406
<input type="checkbox"/> P61058	18"Wx18"D Ensolite® Front Open Contoured Seat (A-5.5"xB-8.25" opening, 2" waterfall foam)	\$458
<input type="checkbox"/> P61086	18"Wx18"D Ensolite® Solid Seat (2" foam)	\$458
<input type="checkbox"/> P61122	18"Wx20"D Ensolite® Solid Seat (1" foam)	\$583
<input type="checkbox"/> P61121	18"Wx20"D Ensolite® Front/Rear Open Seat (A-4.5"xB-7.5" opening, 1" foam)	\$619
<input type="checkbox"/> PP61038	18"Wx20"D Comfortuff Side Open Seat (A-5"xB-8" opening, 1.5" waterfall foam)	\$619
<input type="checkbox"/> P61038	20"Wx18"D Comfortuff Front Open Seat (A-5"xB-8" opening, 1.5" waterfall foam)	\$619
<input type="checkbox"/> P60903	20"Wx18"D Ensolite® Front/Rear Open Seat (A-4.5"xB-7.5" opening, 1" foam)	\$619
<input type="checkbox"/> PP61121	20"Wx18"D Ensolite® Side Open Seat (A-4.5"xB-7.5" opening, 1" foam)	\$619
<input type="checkbox"/> PP61122	20"Wx18"D Ensolite® Solid Seat (1" foam)	\$619
<input type="checkbox"/> P61123	20"Wx20"D Ensolite® Front/Rear Open Seat (A-5"xB-8" opening, 1" waterfall foam)*	\$662
<input type="checkbox"/> P60905	22"Wx18"D Ensolite® Front/Rear Open Seat (A-4.5"xB-7.5" opening, 1" foam)	\$702
<input type="checkbox"/> P61126	22"Wx20"D Ensolite® Front/Rear Open Seat (A-5"xB-8" opening, 1" waterfall foam) \$749	

*Seat works in all 4 positions

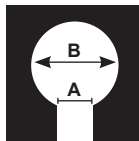

Seat Opening Measurements

Armrests - must match frame depth, must select right and left armrest

<input type="checkbox"/> P13729	18"D Left Hand Armrest with Pad	\$162
<input type="checkbox"/> P13730	18"D Right Hand Armrest with Pad	\$162
<input type="checkbox"/> P13731	18"D Left Hand Armrest with Arm Trough	\$271
<input type="checkbox"/> P13732	18"D Right Hand Armrest with Arm Trough	\$271
<input type="checkbox"/> P13735	20"D Left Hand Armrest with Pad	\$219
<input type="checkbox"/> P13736	20"D Right Hand Armrest with Pad	\$219
<input type="checkbox"/> P13737	20"D Left Hand Armrest with Arm Trough	\$344
<input type="checkbox"/> P13738	20"D Right Hand Armrest with Arm Trough	\$344
<input type="checkbox"/> P13563	Left Hand Height-Adjustable Arms (P13564 required)	\$318
<input type="checkbox"/> P13564	Right Hand Height-Adjustable Arms (P13563 required)	\$318

Ship To:

Name: _____
Address: _____
City/State: _____
Zip: _____
Phone: _____
Tag For: _____

Email form to orders@activeaid.com

Fax this form to 888.224.8622

Leg Rests - foot plate not included

<input type="checkbox"/> PL13725	Left Leg Rest	\$151
<input type="checkbox"/> PR13725	Right Leg Rest	\$151
<input type="checkbox"/> P13571	Left Elevating Leg Rest	\$585
<input type="checkbox"/> P13572	Right Elevating Leg Rest	\$585

Foot Plates

<input type="checkbox"/> PL11099	Left Foot Plate	\$22
<input type="checkbox"/> PR11099	Right Foot Plate	\$22
<input type="checkbox"/> PL11100	Left Foot Plate with Heel Loop	\$34
<input type="checkbox"/> PR11100	Right Foot Plate with Heel Loop	\$34
<input type="checkbox"/> P13891	Left Oversized Aluminum Foot Plate	\$174
<input type="checkbox"/> P13892	Right Oversized Aluminum Foot Plate	\$174
<input type="checkbox"/> PL11101	Left Padded Foot Plate	\$82
<input type="checkbox"/> PR11101	Right Padded Foot Plate	\$82

Backs - frame, seat, back and pan must match same widths and depths, must select one

<input type="checkbox"/> P13745	16"W Sling Back	\$546
<input type="checkbox"/> P13746	16"W Solid Back	\$858
<input type="checkbox"/> P13747	18"W Sling Back	\$598
<input type="checkbox"/> P13748	18"W Solid Back	\$650
<input type="checkbox"/> P13750	20"W Sling Back	\$666
<input type="checkbox"/> P13751	20"W Solid Back	\$947
<input type="checkbox"/> P13752	22"W Sling Back	\$774
<input type="checkbox"/> P13753	22"W Solid Back	\$1,055

Belts

<input type="checkbox"/> PW60884	Waist Belt (62", 64", 66" or 68" circumference with 12" overlap)	\$73
<input type="checkbox"/> PT60884	Trunk Belt (62", 64", 66", or 68" circumference with 12" overlap)	\$73
<input type="checkbox"/> P60879	Calf Strap (not available with P13571 and P13572 elevating leg rests)	\$73
<input type="checkbox"/> P11093	Bodypoint® Trunk Belt	\$224
<input type="checkbox"/> P11102	Bodypoint® Trunk Belt (pair)	\$423
<input type="checkbox"/> P11116	Bodypoint® Trunk Belt & Waist Belt	\$277
<input type="checkbox"/> P11112	Bodypoint® XL Trunk Belt	\$234
<input type="checkbox"/> P11113	Bodypoint® Belt w/Quick Release Knobs	\$260
<input type="checkbox"/> P61169	Bodypoint® Calf Strap (only available with 16"W frame, not available with P13571 and P13572 elevating leg rests)	\$146
<input type="checkbox"/> P61170	Bodypoint® Calf Strap (only available with 20"W frame, not available with P13571 and P13572 elevating leg rests)	\$146
<input type="checkbox"/> P61081	Bodypoint® Calf Strap (only available with 18"W back, not available with P13571 and P13572 elevating leg rests)	\$146
<input type="checkbox"/> P11114	Bodypoint® Knee Belt	\$240

Positioning Aids

<input type="checkbox"/> PL13574	Left Hand Swing-Away Adjustable Lateral	\$352
<input type="checkbox"/> PR13574	Right Hand Swing-Away Adjustable Lateral	\$352
<input type="checkbox"/> PL13618	Left Hand Arm-Mounted Hip Guide (not available with P13615 Armrests)	\$336
<input type="checkbox"/> PR13618	Right Hand Arm-Mounted Hip Guide (not available with P13616 Armrests)	\$336
<input type="checkbox"/> P61006	Abductor/Deflector-Large	\$223

Pans - frame, seat, back and pan must match same widths and depths

<input type="checkbox"/> P13833	16"Wx18"D Pan/Hanger	\$130
<input type="checkbox"/> P13834	18"Wx18"D Pan/Hanger	\$130
<input type="checkbox"/> P13835	18"Wx20"D Pan/Hanger	\$142
<input type="checkbox"/> P13836	20"Wx18"D Pan/Hanger	\$152
<input type="checkbox"/> P13837	20"Wx20"D Pan/Hanger	\$163
<input type="checkbox"/> P13838	22"Wx18"D Pan/Hanger	\$174
<input type="checkbox"/> P13839	22"Wx20"D Pan/Hanger	\$185

Head Supports

<input type="checkbox"/> P13900	Head Support-Large	\$385
<input type="checkbox"/> P13913	Head Support-XL	\$504