

480 Rehab Shower/Commode Chair

MSRP Itemized Price List/Order Form

350 lb. Weight Capacity

Effective September 1, 2020

ActiveAid

101 Activeaid Road
Redwood Falls, MN 56283
ph. 800.533.5330 fax 888.224.8622

Bill To:

Date: _____
P.O.#: _____
Quote#: _____
Account#: _____
Ordered By: _____
Supplier Company: _____
Address: _____
City, State, Zip: _____
Phone: _____
Email: _____

Choose Frame Color Black White (if no selection is made, white will be selected)

Frames - must select one

<input type="checkbox"/> P13633	16"Wx16"D Stainless Steel Frame	\$700
<input type="checkbox"/> P13634	18"Wx16"D Stainless Steel Frame	\$800
<input type="checkbox"/> P13813	16"Wx16"D Stainless Steel Frame Left Side Open	\$1,600
<input type="checkbox"/> P13814	16"Wx16"D Stainless Steel Frame Right Side Open	\$1,600
<input type="checkbox"/> P13815	18"Wx16"D Stainless Steel Frame Left Side Open	\$1,700
<input type="checkbox"/> P13816	18"Wx16"D Stainless Steel Frame Right Side Open	\$1,700

Wheels - must select one wheel option, wheel size and hand rim size must match

<input type="checkbox"/> P13627	8" Wheels (must select P60532 Wheel Locks, pair)	\$160
<input type="checkbox"/> P13860	20" Wheels (pair)	\$350
<input type="checkbox"/> P13863	20" Pneumatic Street Tread Wheels (pair)	\$450
<input type="checkbox"/> P13862	24" Wheels (pair)	\$350
<input type="checkbox"/> P13864	24" Pneumatic Street Tread Wheels (pair)	\$450
<input type="checkbox"/> P13865	24" Flat Free Street Tread Wheels (pair)	\$450
<input type="checkbox"/> P13855	20" PVC Handrims (replaces standard handrims,pair)	\$265
<input type="checkbox"/> P13857	24" PVC Handrims (replaces standard handrims,pair)	\$265

Axles - must select one if 20" or 24" wheels were selected

<input type="checkbox"/> P13604	Bolted Axles (pair)	\$25
---------------------------------	---------------------	------

Wheel Locks - must select one

<input type="checkbox"/> P60532	Wheel Locks (required for P13627, 8" wheels, pair)	\$105
<input type="checkbox"/> P13135	Wheel Locks with Extended Handle (pair)	\$140

Front Casters - must select one

<input type="checkbox"/> P13626	8" Casters (pair)	\$230
<input type="checkbox"/> P13625	8" Casters with Pin Locks (pair)	\$340

Seats - must match same frame width, must select one

<input type="checkbox"/> P60593	16"Wx16"D Ensolite® Front/Rear Open Seat (A-4.5"xB-7.75", 2" foam)	\$330
<input type="checkbox"/> P60598	16"Wx16"D Ensolite® Hourglass Seat (A-8"xB-9.25" opening, 2" foam)	\$330
<input type="checkbox"/> P61091	16"Wx16"D Ensolite® Solid Seat (2" foam)	\$390
<input type="checkbox"/> P60725	18"Wx16"D Ensolite® Oval Seat (A-7.75"xB-9", 2" foam)	\$330
<input type="checkbox"/> P61092	18"Wx16"D Ensolite® Solid Seat (2" foam)	\$390
<input type="checkbox"/> P60722	18"Wx16"D Ensolite® Front/Rear Open Seat (4.5"x7.5" opening, 2" foam)	\$330
<input type="checkbox"/> P60728	18"Wx16"D Ensolite® Hourglass Seat (A-8"xB-9.25" opening, 2")	\$330

Oval Opening
Measurements

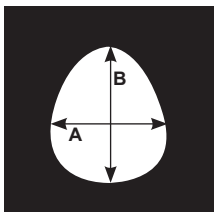

Front/Rear Open Seat
Opening Measurements

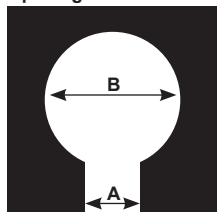

Hourglass Seat
Opening Measurements

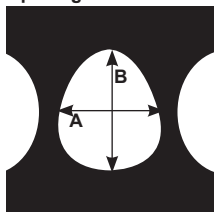

Ship To:

Name: _____
Address: _____
City/State: _____
Zip: _____
Phone: _____
Tag For: _____

Email form to orders@activeaid.com
Fax this form to 888.224.8622

Armrests - must select right and left armrest

<input type="checkbox"/> P13021	Left Hand Armrest with Pad	\$125
<input type="checkbox"/> P13022	Right Hand Armrest with Pad	\$125
<input type="checkbox"/> P13630	Left Hand Armrest with Arm Trough	\$235
<input type="checkbox"/> P13631	Right Hand Armrest with Arm Trough	\$235

Leg Rests - foot plate not included

<input type="checkbox"/> PL13632	Left Leg Rest	\$115
<input type="checkbox"/> PR13632	Right Leg Rest	\$115

Foot Plates

<input type="checkbox"/> PL11099	Left Foot Plate	\$20
<input type="checkbox"/> PR11099	Right Foot Plate	\$20
<input type="checkbox"/> PL11100	Left Foot Plate with Heel Loop	\$30
<input type="checkbox"/> PR11100	Right Foot Plate with Heel Loop	\$30
<input type="checkbox"/> P13891	Left Oversized Aluminum Foot Plate	\$160
<input type="checkbox"/> P13892	Right Oversized Aluminum Foot Plate	\$160
<input type="checkbox"/> PL11101	Left Padded Foot Plate	\$75
<input type="checkbox"/> PR11101	Right Padded Foot Plate	\$75

Backs - frame, seat and back must match same widths, must select one

<input type="checkbox"/> P13628	16"W Solid Back (contoured)	\$215
<input type="checkbox"/> P13629	18"W Solid Back (contoured)	\$235

Belts

<input type="checkbox"/> PW60909	Waist Belt (48" circumference with 12" velcro overlap)	\$60
<input type="checkbox"/> PT60909	Trunk Belt (48" circumference with 12" velcro overlap)	\$60
<input type="checkbox"/> P11093	Bodypoint® Trunk Belt	\$195
<input type="checkbox"/> P11102	Bodypoint® Trunk Belt (pair)	\$390
<input type="checkbox"/> P11103	Bodypoint® Trunk Belt & Waist Belt	\$255

Positioning Aids

<input type="checkbox"/> PL13796	Left Hand Swing-Away Adjustable Lateral	\$325
<input type="checkbox"/> PR13796	Right Hand Swing-Away Adjustable Lateral	\$325

Notes