

720 Bariatric Rehab Shower/Commode Chair

MSRP Itemized Order Form

600 lb. Weight Capacity

Effective February 13th, 2023

ActiveAid

101 Activeaid Road
Redwood Falls, MN 56283
ph. 800.533.5330 fax 888.224.8622

Bill To:

Date: _____

P.O.#: _____

Quote#: _____

Account#: _____

Ordered By: _____

Supplier Company: _____

Address: _____

City, State, Zip: _____

Phone: _____

Email: _____

Choose Frame Color ☐ Black ☐ White (if no selection is made, white will be selected)

Frames - frame, seat, back and pan must match same widths and depths, must select one

<input type="checkbox"/> P13598	20"Wx20"D Stainless Steel Frame	\$1,300
<input type="checkbox"/> P13599	22"Wx20"D Stainless Steel Frame	\$1,400
<input type="checkbox"/> P13600	24"Wx20"D Stainless Steel Frame	\$1,500
<input type="checkbox"/> P13601	26"Wx20"D Stainless Steel Frame	\$1,700
<input type="checkbox"/> P13602	28"Wx20"D Stainless Steel Frame	\$1,900
<input type="checkbox"/> P13603	30"Wx20"D Stainless Steel Frame	\$2,200

Frame Accessories

<input type="checkbox"/> P13670	Front Anti-Tippers (required with 1-pc foot plate/leg rest)	\$260
--	---	-------

Wheels/Rear Casters - must select one wheel or caster option, wheel size and hand rim size must match

<input type="checkbox"/> P13283-2	6" Locking Rear Casters (pair)	\$318
<input type="checkbox"/> P13860	20" Solid Shallow Tread Wheels (pair)	\$470
<input type="checkbox"/> P13863	20" Pneumatic Deep Tread Wheels (pair)	\$470
<input type="checkbox"/> P13862	24" Solid Shallow Tread Wheels (pair)	\$470
<input type="checkbox"/> P13864	24" Pneumatic Street Tread Wheels (pair)	\$470
<input type="checkbox"/> P13865	24" Pneumatic Flat Free Deep Tread Wheels (pair)	\$470
<input type="checkbox"/> P13855	20" PVC Handrims (replaces standard handrims, pair)	\$276
<input type="checkbox"/> P13857	24" PVC Handrims (replaces standard handrims, pair)	\$276

Axles - must select one if wheels were selected

<input type="checkbox"/> P13769	Bolted Axles with Anti-Tipping Levers (pair)	\$73
--	--	------

Wheel Locks - must select one if wheels were selected

<input type="checkbox"/> P13975	Wheel Locks (pair)	\$110
<input type="checkbox"/> P13976	Wheel Locks with Extended Handle (pair)	\$146

Front Casters - must select one

<input type="checkbox"/> P60780-2	6" Casters (pair)	\$240
<input type="checkbox"/> P13283-2	6" Locking Casters (pair)	\$318

Seats - frame, seat, back and pan must match same widths and depths, must select one

<input type="checkbox"/> P60886	20"Wx20"D Ensolite® Race Track Oval Seat (A-7.75"xB-12.75" opening, 1.5" foam)	\$610
<input type="checkbox"/> P61117	20"Wx20"D Ensolite® Front/Rear Open Seat (A-4.5"xB-7.75" opening, 1" foam)	\$550
<input type="checkbox"/> P60887	22"Wx20"D Ensolite® Race Track Oval Seat (A-7.75"xB-12.75" opening, 1.5" foam)	\$650
<input type="checkbox"/> P61118	22"Wx20"D Ensolite® Front/Rear Open Seat (A-4.5"xB-7.75" opening, 1" foam)	\$650
<input type="checkbox"/> P60888	24"Wx20"D Ensolite® Race Track Oval Seat (A-7.75"xB-12.75" opening, 1.5" foam)	\$665
<input type="checkbox"/> P61119	24"Wx20"D Ensolite® Front/Rear Open Seat (A-4.5"xB-7.75" opening, 1" foam)	\$665
<input type="checkbox"/> P60889	26"Wx20"D Ensolite® Race Track Oval Seat (A-7.75"xB-12.75" opening, 1.5" foam)	\$680
<input type="checkbox"/> P61110	28"Wx20"D Ensolite® Race Track Oval Seat (A-7.75"xB-12.75" opening, 1.5" foam)	\$720
<input type="checkbox"/> P61111	30"Wx20"D Ensolite® Race Track Oval Seat (A-7.75"xB-12.75" opening, 1.5" foam)	\$740

Front/Rear Seat
Opening Measurements

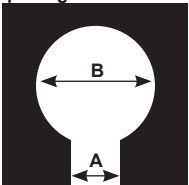

Race Track Seat Opening
Measurements

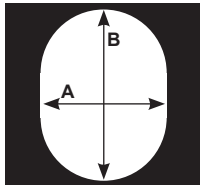

Ship To:

Name: _____

Address: _____

City/State: _____

Zip: _____

Phone: _____

Tag For: _____

Email form to orders@activeaid.com

Fax this form to 888.224.8622

Armrests - must select right and left armrest

<input type="checkbox"/> P13584	Left Hand Armrest with Pad	\$167
<input type="checkbox"/> P13585	Right Hand Armrest with Pad	\$167
<input type="checkbox"/> P13586	Left Hand Armrest with Arm Trough	\$281
<input type="checkbox"/> P13587	Right Hand Armrest with Arm Trough	\$281

Leg Rests - foot plate not included unless stated in description

<input type="checkbox"/> PL13581	Left Gooseneck Leg Rest	\$145
<input type="checkbox"/> PR13581	Right Gooseneck Leg Rest	\$145
<input type="checkbox"/> P13582	Left Elevating Leg Rest	\$562
<input type="checkbox"/> P13583	Right Elevating Leg Rest	\$562
<input type="checkbox"/> P13196	20"W 1-pc. Foot Plate/Leg Rest-must match frame width, foot plate included, P13670 required	\$320
<input type="checkbox"/> P13184	22"W 1-pc. Foot Plate/Leg Rest-must match frame width, foot plate included, P13670 required	\$330
<input type="checkbox"/> P13197	24"W 1-pc. Foot Plate/Leg Rest-must match frame width, foot plate included, P13670 required	\$340
<input type="checkbox"/> P13198	26"W 1-pc. Foot Plate/Leg Rest-must match frame width, foot plate included, P13670 required	\$350
<input type="checkbox"/> P13579	28"W 1-pc. Foot Plate/Leg Rest-must match frame width, foot plate included, P13670 required	\$360
<input type="checkbox"/> P13580	30"W 1-pc. Foot Plate/Leg Rest-must match frame width, foot plate included, P13670 required	\$375

Foot Plates cannot be ordered with one piece foot plate/leg rest

<input type="checkbox"/> PL11099	Left Foot Plate	\$21
<input type="checkbox"/> PR11099	Right Foot Plate	\$21
<input type="checkbox"/> PL11100	Left Foot Plate with Heel Loop	\$32
<input type="checkbox"/> PR11100	Right Foot Plate with Heel Loop	\$32
<input type="checkbox"/> P13891	Left Oversized Aluminum Foot Plate	\$167
<input type="checkbox"/> P13892	Right Oversized Aluminum Foot Plate	\$167
<input type="checkbox"/> PL11101	Left Padded Foot Plate	\$78
<input type="checkbox"/> PR11101	Right Padded Foot Plate	\$78

Backs - frame, seat and back must match same widths, must select one

<input type="checkbox"/> P13592	20"W Contoured Solid Back	\$520
<input type="checkbox"/> P13593	22"W Solid Back	\$572
<input type="checkbox"/> P13594	24"W Solid Back	\$624
<input type="checkbox"/> P13595	26"W Solid Back	\$676
<input type="checkbox"/> P13596	28"W Solid Back	\$780
<input type="checkbox"/> P13597	30"W Solid Back	\$884

Belts

<input type="checkbox"/> PT60884	Trunk Belt (66", 68", 72", 74" and 76" circumference with 12" overlap)	\$70
<input type="checkbox"/> PW60884	Waist Belt (for 20"W, 22"W and 24"W frames only, 66", 68" and 70" circumference with 12" overlap)	\$70
<input type="checkbox"/> PW11095	Waist Belt (for 26"W frames only, 76" circumference with 12" overlap)	\$84
<input type="checkbox"/> P11093	Bodypoint® Trunk Belt (for 20"W and 22"W frames only)	\$215
<input type="checkbox"/> P11102	Bodypoint® Trunk Belt (for 20"W and 22"W frames only, pair)	\$406
<input type="checkbox"/> P11116	Bodypoint® Trunk Belt & Waist Belt (fo 20"W and 22"W frames only)	\$266
<input type="checkbox"/> P11112	Bodypoint® XL Trunk Belt (for 24"W and 26"W frames only)	\$225
<input type="checkbox"/> P11113	Bodypoint® Belt w/Quick Release Knobs (for 20"W and 22"W frames only)	\$250

Pans - frame, seat, back and pan must match same widths and depths

<input type="checkbox"/> P13844	20"Wx20"D Pan/Hanger	\$136
<input type="checkbox"/> P13845	22"Wx20"D Pan/Hanger	\$146
<input type="checkbox"/> P13846	24"Wx20"D Pan/Hanger	\$156
<input type="checkbox"/> P13847	26"Wx20"D Pan/Hanger	\$167
<input type="checkbox"/> P13848	28"Wx20"D Pan/Hanger	\$177
<input type="checkbox"/> P13849	30"Wx20"D Pan/Hanger	\$188