

800 Rehab Shower/Commode Chair-Seat Height Adjustable MSRP Itemized Price List/Order Form

350 lb. Weight Capacity

Effective May 1, 2019

ActiveAid

101 Activeaid Road
Redwood Falls, MN 56283
ph. 800.533.5330 fax 888.224.8622

Bill To:

Date: _____
P.O.#: _____
Quote#: _____
Account#: _____
Ordered By: _____
Supplier Company: _____
Address: _____
City, State, Zip: _____
Phone: _____
Email: _____

Ship To:

Name: _____
Address: _____
City/State: _____
Zip: _____
Phone: _____
Tag For: _____

**Email form to orders@activeaid.com
Fax this form to 888.224.8622**

Frames - must select one

P13700 18"Wx18"D White Stainless Steel Frame \$815

Wheels/Rear Casters - must select one wheel or caster option

60800-2 5" Dual Locking Casters (pair) \$125
 P61096 24" Wheels (pair) \$350
 P60549 24" Pneumatic Street Tread Wheels (pair) \$450
 P61059 24" Flat Free Street Tread Wheels (pair) \$450
 P61104 24" PVC Handrims (replaces standard handrims, pair) \$265

Axles - must select one if wheels were selected

P13701 Bolted Axles with Wheel Mounts and Tipping Levers (pair) \$220

Wheel Locks - must select one one if wheels were selected

P60532 Wheel Locks (pair) \$105
 P13135 Wheel Locks with Extended Handle (pair) \$140

Front Casters - must select one

60841-2 5" Casters (pair) \$105
 60800-2 5" Dual Locking Casters (pair) \$125

Seats - must select one

P60993 18"Wx18"D Comfortuff Front/Rear Open Seat (A-5"xB-8" opening, 1.5" waterfall foam) \$350
 P60974 18"Wx18"D Comfortuff Contoured Front Open Seat (A-4"xB-6.5" opening, sloped foam) \$375
 P60913 18"Wx18"D Ensolite® Front/Rear Open Seat (A-5.25"xB-8" opening, 2" waterfall foam) \$340
*Seat works in all 4 positions

Front Open Seat
Opening Measurements

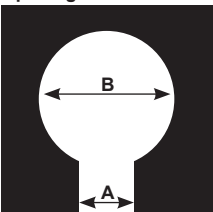

Armrests - must select right and left armrest

P13694 Left Hand Armrest with Pad \$140
 P13695 Right Hand Armrest with Pad \$140
 P13696 Left Hand Armrest with Arm Trough \$250
 P13697 Right Hand Armrest with Arm Trough \$250
 P13615 Left Hand Height-Adjustable Armrest \$280
 P13616 Right Hand Height-Adjustable Armrest \$280

Leg Rests - foot plate not included

PL13698 Left Leg Rest \$120
 PR13698 Right Leg Rest \$120

Foot Plates - cannot be ordered with one piece foot plate/leg rest

PL11099 Left Foot Plate \$20
 PR11099 Right Foot Plate \$20
 PL11100 Left Foot Plate with Heel Loop \$30
 PR11100 Right Foot Plate with Heel Loop \$30
 P61137 Left Oversized Aluminum Foot Plate \$160
 P61138 Right Oversized Aluminum Foot Plate \$160
 PL11101 Left Padded Foot Plate \$75
 PR11101 Right Padded Foot Plate \$75

Backs - must select one

P13690 18"W Sling Back with Stroller Handles \$315
 P13692 18"W Sling Back with Stroller Handles (adjustable depth) \$440
 P13691 18"W Solid Back \$315
 P13693 18"W Solid Back (adjustable depth) \$440

Belts

PW60909 Waist Belt (48" circumference with 12" velcro overlap) \$60
 PT60909 Trunk Belt (48" circumference with 12" velcro overlap) \$60
 P11093 Bodypoint® Trunk Belt \$195
 P11102 Bodypoint® Trunk Belt (pair) \$390
 P11103 Bodypoint® Trunk Belt & Waist Belt \$255
 P11114 Bodypoint® Knee Belt \$195

Positioning Aids

PL13574 Left Hand Swing-Away Adjustable Lateral \$325
 PR13574 Right Hand Swing-Away Adjustable Lateral \$325

Pans

P13699 18"Wx18"D Pan/Hanger \$110

Notes

