

9000 Rehab Shower/Commode Chair-Folding

MSRP Itemized Price List/Order Form

350 lb. Weight Capacity
Effective May 1, 2019

ActiveAid

101 Activeaid Road
Redwood Falls, MN 56283
ph. 800.533.5330 fax 888.224.8622

Bill To:

Date: _____
P.O.#: _____
Quote#: _____
Account#: _____
Ordered By: _____
Supplier Company: _____
Address: _____
City, State, Zip: _____
Phone: _____
Email: _____

Ship To:

Name: _____
Address: _____
City/State: _____
Zip: _____
Phone: _____
Tag For: _____

**Email form to orders@activeaid.com
Fax this form to 888.224.8622**

Choose Frame Color Black White (if no selection is made, white will be selected)

Frames - must select one

P13607 18"Wx18"D Stainless Steel Frame \$1,360

Wheels - must select one wheel option

P61096 24" Wheels (pair) \$350
 P60549 24" Pneumatic Street Tread Wheels (pair) \$450
 P61059 24" Flat Free Street Tread Wheels (pair) \$450
 P61104 24" PVC Handrims (replaces standard handrims, pair) \$265

Axles - must select one

P13604 Bolted Axles (pair) \$25
 P70245 Quick Release Axles (pair) \$100

Wheel Locks - must select one

P60532 Wheel Locks (pair) \$105
 P13724 Wheel Locks with Extended Handle (pair) \$140

Casters - must select one

60841-2 5" Casters (pair) \$105
 60800-2 5" Dual Locking Casters (pair) \$125

Seats - must select one

P61063 18"Wx18"D Ensolite® Front Open Contoured Seat (A-4.25"xB-7.5" opening, 2" foam) \$375
 P61062 18"Wx18"D Ensolite® Oval Contoured Seat (A-7.25"xB-11" opening, 2" foam) \$375

Seat Opening Measurements

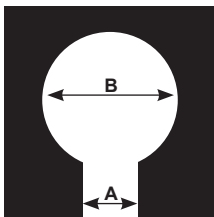

Oval Seat Opening Measurements

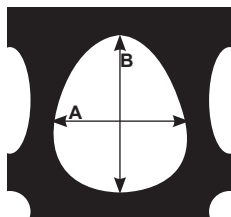

Armrests - must select right and left armrest

P13605 Left Hand Armrest \$130
 P13606 Right Hand Armrest \$130

Leg Rests - foot plate not included

PL13570 Left Low-Mount Leg Rest \$115
 PR13570 Right Low-Mount Leg Rest \$115
 P13794 Left Elevating Leg Rest \$540
 P13795 Right Elevating Leg Rest \$540

Foot Plates

PL11099 Left Foot Plate \$20
 PR11099 Right Foot Plate \$20
 PL11100 Left Foot Plate with Heel Loop \$30
 PR11100 Right Foot Plate with Heel Loop \$30
 P61137 Left Oversized Aluminum Foot Plate \$160
 P61138 Right Oversized Aluminum Foot Plate \$160
 PL11101 Left Padded Foot Plate \$75
 PR11101 Right Padded Foot Plate \$75

Back- must select one

P60915 18"W Sling Back \$120

Belts

PW60910 Waist Belt (48" circumference with 12" velcro overlap) \$60
 PT60910 Trunk Belt (48" circumference with 12" velcro overlap) \$60
 P60879 Calf Strap (not available with P13794 and P13795 elevating leg rests) \$60
 P11093 Bodypoint® Trunk Belt \$195
 P11102 Bodypoint® Trunk Belt (pair) \$390
 P11111 Bodypoint® Trunk Belt & Waist Belt \$255
 P11112 Bodypoint® XL Trunk Belt \$205
 P11113 Bodypoint® Belt w/Quick Release Knobs \$240
 P61081 Bodypoint® Calf Strap (only available with 18" back, not available with P13794 and P13795 elevating leg rests) \$125
 P11114 Bodypoint® Knee Belt \$195

Pans

P13495 18"Wx18"D Pan/Hanger \$120

Notes
