

# 922 Rehab Shower/Commode Chair-Folding Package-Order Form

350 lb. Weight Capacity

Effective January 1, 2024

# ActiveAid

101 Activeaid Road  
Redwood Falls, MN 56283  
ph. 800.533.5330 fax 888.224.8622

## Bill To:

Date: \_\_\_\_\_  
P.O.#: \_\_\_\_\_  
Quote#: \_\_\_\_\_  
Account#: \_\_\_\_\_  
Ordered By: \_\_\_\_\_  
Supplier Company: \_\_\_\_\_  
Address: \_\_\_\_\_  
City, State, Zip: \_\_\_\_\_  
Phone: \_\_\_\_\_  
Email: \_\_\_\_\_

## Ship To:

Name: \_\_\_\_\_  
Address: \_\_\_\_\_  
City/State: \_\_\_\_\_  
Zip: \_\_\_\_\_  
Phone: \_\_\_\_\_  
Tag For: \_\_\_\_\_

**Email form to [orders@activeaid.com](mailto:orders@activeaid.com)  
Fax this form to 888.224.8622**

## Packages:

### PKG301 Package #1 \$3,722

**Package #1 Includes: (no substitutions)**

18"Wx18"D Stainless Steel Frame, 22" Solid Shallow Tread Wheels, 5" Casters, Bolted Axles, Wheel Locks, 18"Wx18"D Ensolite® Front Open Seat, Left Hand Height-Adjustable Armrest, Right Hand Height-Adjustable Armrest, Left Gooseneck Leg Rest, Right Gooseneck Leg Rest, Left Foot Plate, Right Foot Plate, 18"W Sling Back, Waist Belt, and Pan/Hanger.

**Choose Frame Color**    Black    White (if no selection is made, white will be selected)

### PKG302 Package #2 \$3,666

**Package #2 Includes: (no substitutions)**

18"Wx18"D Stainless Steel Frame, 24" Solid Shallow Tread Wheels, 5" Casters, Quick Release Axles, Wheel Locks, Seat, Left Hand Flip-Up Armrest, Right Hand Flip-Up Armrest, Left Gooseneck Leg Rest, Right Gooseneck Leg Rest, Left Foot Plate, Right Foot Plate, 18"W Sling Back, Waist Belt, and Pan/Hanger.

**Seats- must select one**

- P60993** 18"Wx18"D Comfortuff Front Open Seat  
(A-5"xB-8" opening, 2.5" waterfall foam)
- PP60974** 18"Wx18"D Comfortuff Contoured Front Open Seat  
(A-4"xB-6.5" opening, sloped foam)
- P61120** 18"Wx18"D Ensolite® Front Open (DEFAULT CHOICE)  
(A-3"xB-5.25", 2"dual density foam w/coccyx notch)
- PP61058** 18"Wx18"D Ensolite® Front Open Contoured Seat  
(A-5.5"xB-8.25" opening, 2" waterfall foam)
- P60675** 18"Wx18"D Ensolite® Cloverleaf Seat  
(7.5"x9" oval opening, 1" foam)
- PP60701** 18"Wx18"D Ensolite® Front/Rear Open Seat  
(A-4.5"xB-7.75", 1" foam)
- PP60850** 18"Wx18"D Ensolite® Front/Rear Open Seat  
(A-5"xB-8" opening, 1" waterfall foam)
- P60913** 18"Wx18"D Ensolite® Front/Rear Open Seat  
(A-5.25"xB-8" opening, 2" waterfall foam)

**Choose Frame Color**    Black    White (if no selection is made, white will be selected)

### PKG303 Package #3 \$5,369

**Package #3 Includes: (no substitutions)**

18"Wx18"D Stainless Steel Frame, 24" Solid Shallow Tread Wheels, 24" PVC Handrims, 5" Dual Locking Casters, Quick Release Axles, Wheel Locks with Extended Handle, Seat, Left Hand Height-Adjustable Armrest, Right Hand Height-Adjustable Armrest, Left Elevating Leg Rest, Right Elevating Leg Rest, Left Foot Plate with Heel Loop, Right Foot Plate with Heel Loop, 18"W Solid Back, Bodypoint® Trunk Belts, Waist Belt and Pan/Hanger.

**Seats- must select one**

- P60993** 18"Wx18"D Comfortuff Front Open Seat  
(A-5"xB-8" opening, 2.5" waterfall foam)
- PP60974** 18"Wx18"D Comfortuff Contoured Front Open Seat  
(A-4"xB-6.5" opening, sloped foam)
- P61120** 18"Wx18"D Ensolite® Front Open (DEFAULT CHOICE)  
(A-3"xB-5.25", 2"dual density foam w/coccyx notch)
- PP61058** 18"Wx18"D Ensolite® Front Open Contoured Seat  
(A-5.5"xB-8.25" opening, 2" waterfall foam)
- P60675** 18"Wx18"D Ensolite® Cloverleaf Seat  
(7.5"x9" oval opening, 1" foam)
- PP60701** 18"Wx18"D Ensolite® Front/Rear Open Seat  
(A-4.5"xB-7.75", 1" foam)
- PP60850** 18"Wx18"D Ensolite® Front/Rear Open Seat  
(A-5"xB-8" opening, 1" waterfall foam)
- P60913** 18"Wx18"D Ensolite® Front/Rear Open Seat  
(A-5.25"xB-8" opening, 2" waterfall foam)

**Choose Frame Color**    Black    White (if no selection is made, white will be selected)

**Front/Rear Open Seat  
Opening Measurements**

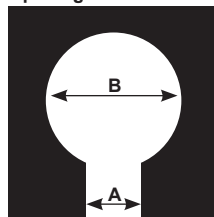

**Cloverleaf Seat Opening  
Measurements**

