

922 Rehab Shower/Commode Chair-Folding Package-Order Form

350 lb. Weight Capacity

Effective July 20, 2022

ActiveAid

101 Activeaid Road
Redwood Falls, MN 56283
ph. 800.533.5330 fax 888.224.8622

Bill To:

Date: _____
P.O.#: _____
Quote#: _____
Account#: _____
Ordered By: _____
Supplier Company: _____
Address: _____
City, State, Zip: _____
Phone: _____
Email: _____

Ship To:

Name: _____
Address: _____
City/State: _____
Zip: _____
Phone: _____
Tag For: _____

**Email form to orders@activeaid.com
Fax this form to 888.224.8622**

Packages:

PKG301 Package #1 \$3,555

Package #1 Includes: (no substitutions)

18"Wx18"D Stainless Steel Frame, 22" Solid Shallow Tread Wheels, 5" Casters. Bolted Axles, Wheel Locks, 18"Wx18"D Ensolite® Front Open Seat, Left Hand Height-Adjustable Armrest, Right Hand Height-Adjustable Armrest, Left Gooseneck Leg Rest, Right Gooseneck Leg Rest, Left Foot Plate, Right Foot Plate, 18"W Sling Back, Waist Belt, and Pan/Hanger.

Choose Frame Color Black White (if no selection is made, white will be selected)

PKG302 Package #2 \$3,556

Package #2 Includes: (no substitutions)

18"Wx18"D Stainless Steel Frame, 24" Solid Shallow Tread Wheels, 5" Casters, Quick Release Axles, Wheel Locks, Seat, Left Hand Flip-Up Armrest, Right Hand Flip-Up Armrest, Left Gooseneck Leg Rest, Right Gooseneck Leg Rest, Left Foot Plate, Right Foot Plate, 18"W Sling Back, Waist Belt, and Pan/Hanger.

Seats- must select one

- P60993** 18"Wx18"D Comfortuff Front Open Seat
(A-5"xB-8" opening, 2.5" waterfall foam)
- PP60974** 18"Wx18"D Comfortuff Contoured Front Open Seat
(A-4"xB-6.5" opening, sloped foam)
- P61120** 18"Wx18"D Ensolite® Front Open (DEFAULT CHOICE)
(A-3"xB-5.25", 2"dual density foam w/coccyx notch)
- PP61058** 18"Wx18"D Ensolite® Front Open Contoured Seat
(A-5.5"xB-8.25" opening, 2" waterfall foam)
- P60675** 18"Wx18"D Ensolite® Cloverleaf Seat
(7.5"x9" oval opening, 1" foam)
- PP60701** 18"Wx18"D Ensolite® Front/Rear Open Seat
(A-4.5"xB-7.75", 1" foam)
- PP60850** 18"Wx18"D Ensolite® Front/Rear Open Seat
(A-5"xB-8" opening, 1" waterfall foam)
- P60913** 18"Wx18"D Ensolite® Front/Rear Open Seat
(A-5.25"xB-8" opening, 2" waterfall foam)

Choose Frame Color Black White (if no selection is made, white will be selected)

PKG303 Package #3 \$5,315

Package #3 Includes: (no substitutions)

18"Wx18"D Stainless Steel Frame, 24" Solid Shallow Tread Wheels, 24" PVC Handrims, 5" Dual Locking Casters, Quick Release Axles, Wheel Locks with Extended Handle, Seat, Left Hand Height-Adjustable Armrest, Right Hand Height-Adjustable Armrest, Left Elevating Leg Rest, Right Elevating Leg Rest, Left Foot Plate with Heel Loop, Right Foot Plate with Heel Loop, 18"W Solid Back, Bodypoint® Trunk Belts, Waist Belt and Pan/Hanger.

Seats- must select one

- P60993** 18"Wx18"D Comfortuff Front Open Seat
(A-5"xB-8" opening, 2.5" waterfall foam)
- PP60974** 18"Wx18"D Comfortuff Contoured Front Open Seat
(A-4"xB-6.5" opening, sloped foam)
- P61120** 18"Wx18"D Ensolite® Front Open (DEFAULT CHOICE)
(A-3"xB-5.25", 2"dual density foam w/coccyx notch)
- PP61058** 18"Wx18"D Ensolite® Front Open Contoured Seat
(A-5.5"xB-8.25" opening, 2" waterfall foam)
- P60675** 18"Wx18"D Ensolite® Cloverleaf Seat
(7.5"x9" oval opening, 1" foam)
- PP60701** 18"Wx18"D Ensolite® Front/Rear Open Seat
(A-4.5"xB-7.75", 1" foam)
- PP60850** 18"Wx18"D Ensolite® Front/Rear Open Seat
(A-5"xB-8" opening, 1" waterfall foam)
- P60913** 18"Wx18"D Ensolite® Front/Rear Open Seat
(A-5.25"xB-8" opening, 2" waterfall foam)

Choose Frame Color Black White (if no selection is made, white will be selected)

**Front/Rear Open Seat
Opening Measurements**

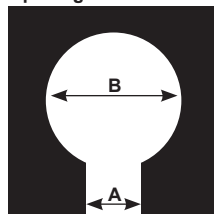

**Cloverleaf Seat Opening
Measurements**

