

101 Rehab Shower/Commode Chair-Bath/Toilet Modular System

350 lb. Weight Capacity  
Effective January 1, 2026

Bill To:

Date: \_\_\_\_\_  
P.O.#: \_\_\_\_\_  
Quote#: \_\_\_\_\_  
Account#: \_\_\_\_\_  
Ordered By: \_\_\_\_\_  
Supplier Company: \_\_\_\_\_  
ATP (REQUIRED): \_\_\_\_\_  
Address: \_\_\_\_\_  
City, State, Zip: \_\_\_\_\_  
Phone: \_\_\_\_\_  
Email: \_\_\_\_\_

Frames - must select one

☒ **PRT50000** 18"Wx18"D Black-Stainless Steel Frame \$153

Legs - must select one

☐ **PRT50001** Short Legs w/Crutch Tips (height seat range from floor to bottom frame-15.5"-18.5") \$166  
☐ **PRT50002** Short Legs w/Suction Cups (height seat range from floor to bottom frame-15.5"-18.5") \$215  
☐ **PRT50003** Long Legs w/Crutch Tips (height seat range from floor to bottom frame-18.5"-21.5") \$172  
☐ **PRT50004** Long Legs w/Suction Cups (height seat range from floor to bottom frame-18.5"-21.5") \$215

Email form to [webquotes@altimatemedical.com](mailto:webquotes@altimatemedical.com)

Ship To:

Name: \_\_\_\_\_  
Address: \_\_\_\_\_  
City/State: \_\_\_\_\_  
Zip: \_\_\_\_\_  
Phone: \_\_\_\_\_  
Tag For: \_\_\_\_\_



Ph: 800.342.8968 or 507.697.6393  
Fax: 877.342.8968 or 507.697.6900  
[webquotes@altimatemedical.com](mailto:webquotes@altimatemedical.com) [activeaid.com](http://activeaid.com)

Seats - must select one

☐ **P61367** 16"Wx18"D Ensolite® Front/Rear Open Seat (A-4.5"xB-7.5" opening, 2" foam)\* \$598  
☐ **P61368** 16"Wx15.5"D Ensolite® Front/Rear Open Seat (A-3.5"xB-6" opening, 2" waterfall foam)\* \$598  
☐ **P61369** 16"Wx16"D Ensolite® Front/Rear Open Seat (A-4"xB-6.5" opening, 1" foam)\* \$598  
☐ **PP61189** 18"Wx18"D Molded Gel Front Open Contoured Seat (A-3.5"xB-7.25" opening, 2.5" gel) \$591  
☐ **PP61190** 18"Wx18"D Molded Foam Oval Contoured Seat (A-7.25"xB-12.5" opening, 2.25" foam) \$507  
☐ **PP61191** 18"Wx18"D Molded Gel Oval Contoured Seat (A-7.25"xB-12.5" opening, 2.5" gel) \$591  
☐ **PP61192** 18"Wx18"D Molded Foam Front Open Contoured Seat (A-3.5"xB-7.25" opening, 2.25" foam) \$507  
☐ **P60911** 18"Wx18"D Ensolite® Front/Rear Open Seat (A-4.5"xB-7.5" opening, 1" foam)\* \$598  
☐ **P61370** 18"Wx18"D Ensolite® Front/Rear Open Seat (A-5.25"xB-8" opening, 2" waterfall foam)\* \$598

\*Seat works in all 4 positions

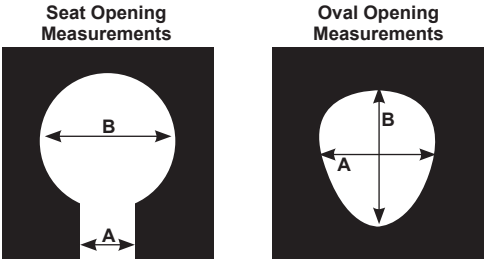

Notes

\_\_\_\_\_

\_\_\_\_\_

\_\_\_\_\_

\_\_\_\_\_

\_\_\_\_\_

\_\_\_\_\_

\_\_\_\_\_

\_\_\_\_\_

\_\_\_\_\_

\_\_\_\_\_



## 202 Rehab Shower/Commode Chair-Bath/Toilet Modular System

350 lb. Weight Capacity

Effective January 1, 2026

### Bill To:

Date: \_\_\_\_\_

P.O.#: \_\_\_\_\_

Quote#: \_\_\_\_\_

Account#: \_\_\_\_\_

Ordered By: \_\_\_\_\_

Supplier Company: \_\_\_\_\_

ATP (REQUIRED): \_\_\_\_\_

Address: \_\_\_\_\_

City, State, Zip: \_\_\_\_\_

Phone: \_\_\_\_\_

Email: \_\_\_\_\_

### Frames - must select one

☒ **P13641** 18"Wx18"D White Stainless Steel Frame \$226

### Legs - must select one

☐ **P13642** Legs w/Crutch Tips (height seat range from floor to bottom frame-16"-19") \$181

☐ **P13643** Legs w/Suction Cups (height seat range from floor to bottom frame-16"-19") \$226

### Seats - must select one

☐ **P60993** 18"Wx18"D Comfortuff Front/Rear Open Seat (A-5"xB-8" opening, 2.5" waterfall foam) \*\$440

☐ **P60913** 18"Wx18"D Ensolite® Front/Rear Open Seat (A-5.25"xB-8" opening, 2" waterfall foam) \*\$497

☐ **P61086** 18"Wx18"D Ensolite® Solid Seat (2" foam) \$497

☐ **P61058** 18"Wx18"D Ensolite® Front Open Seat (A-5.5"xB-8.25" opening, 2" waterfall/contoured foam) \$497

☐ **P60850** 18"Wx18"D Ensolite® Front/Rear Open Seat (A-5"xB-8" opening, 1" waterfall foam) \*\$497

\*Seat works in all 4 positions

#### Seat Opening Measurements

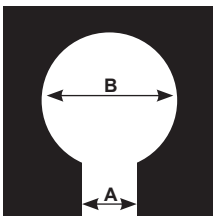

### Notes

---

---

---

---

---

---

---

---

---

---

Email form to [webquotes@altimatemedical.com](mailto:webquotes@altimatemedical.com)

### Ship To:

Name: \_\_\_\_\_

Address: \_\_\_\_\_

City/State: \_\_\_\_\_

Zip: \_\_\_\_\_

Phone: \_\_\_\_\_

Tag For: \_\_\_\_\_

**AltimateMedical**  
creating products · changing lives

Ph: 800.342.8968 or 507.697.6393

Fax: 877.342.8968 or 507.697.6900

[webquotes@altimatemedical.com](mailto:webquotes@altimatemedical.com) [activeaid.com](http://activeaid.com)

### Backs

☐ **P13295** Back Tubes w/Solid Back Pad (13.25"H) \$401

### Armrests

☐ **PL13291** Left Hand Armrest with Pad \$136

☐ **PR13291** Right Hand Armrest with Pad \$136

### Belts - back required

☐ **PW60884** Waist Belt (64" circumference with 12" overlap) \$80

☐ **PT60909** Trunk Belt (54" circumference with 12" overlap) \$80

### Benches

☐ **P13294** B-O Transfer Bench \$395

☐ **P13352** Short Transfer Bench \$395

### Pans

☐ **P13876** 18"Wx18"D Pan/Hanger \$142



# 600 Rehab Shower/Commode Chair

350 lb. Weight Capacity

Effective January 1, 2026

## Bill To:

Date:\_\_\_\_\_

P.O.#:\_\_\_\_\_

Quote#:\_\_\_\_\_

Account#:\_\_\_\_\_

Ordered By:\_\_\_\_\_

Supplier Company:\_\_\_\_\_

ATP (REQUIRED):\_\_\_\_\_

Address:\_\_\_\_\_

City, State, Zip:\_\_\_\_\_

Phone:\_\_\_\_\_

Email:\_\_\_\_\_

## Frames - frame, seat and back must match same widths, must select one

### Choose Frame Color

☐ Black ☐ White (if no selection is made, white will be selected)

<input type="checkbox"/> <b>P13675</b>	18"Wx18"D Stainless Steel Frame	\$817
<input type="checkbox"/> SPECIAL SIZE	18"Wx20"D Stainless Steel Frame	INQUIRE FOR PRICING
<input type="checkbox"/> SPECIAL SIZE	20"Wx18"D Stainless Steel Frame	INQUIRE FOR PRICING
<input type="checkbox"/> SPECIAL SIZE	22"Wx18"D Stainless Steel Frame	INQUIRE FOR PRICING

## Wheels/Rear Casters - must select one wheel or caster option, wheel size and hand rim size must match

<input type="checkbox"/> <b>P60800-2</b>	5" Dual Locking Casters (pair)	\$159
<input type="checkbox"/> <b>P13860</b>	20" Solid Shallow Tread Wheels (pair)	\$530
<input type="checkbox"/> <b>P13863</b>	20" Pneumatic Deep Tread Wheels (pair)	\$530
<input type="checkbox"/> <b>P13862</b>	24" Solid Shallow Tread Wheels (pair)	\$530
<input type="checkbox"/> <b>P13864</b>	24" Pneumatic Deep Tread Wheels (pair)	\$530
<input type="checkbox"/> <b>P13865</b>	24" Pneumatic Flat Free Deep Tread Wheels (pair)	\$530
<input type="checkbox"/> <b>P13855</b>	20" PVC Handrims (replaces standard handrims, pair)	\$312
<input type="checkbox"/> <b>P13857</b>	24" PVC Handrims (replaces standard handrims, pair)	\$312

## Axles - must select one if wheels were selected

<input type="checkbox"/> <b>P13649</b>	Bolted Axles with Wheel Mounts and Anti-Tipping Levers (pair)	\$177
<input type="checkbox"/> <b>P13650</b>	Quick Release Axles with Wheel Mounts and Anti-Tipping Levers (pair)	\$330

## Wheel Locks - must select one if wheels were selected

<input type="checkbox"/> <b>P13975</b>	Wheel Locks (pair)	\$125
<input type="checkbox"/> <b>P13976</b>	Wheel Locks with Extended Handle (pair)	\$166

## Front Casters - must select one

<input type="checkbox"/> <b>P60841-2</b>	5" Casters (pair)	\$136
<input type="checkbox"/> <b>P60800-2</b>	5" Dual Locking Casters (pair)	\$159

## Seats - frame, seat and back must match same widths and depths, must select one

<input type="checkbox"/> <b>P61189</b>	18"Wx18"D Molded Gel Front Open Contoured Seat (A-3.5"xB-7.25" opening, 2.5" gel)	\$591
<input type="checkbox"/> <b>P61190</b>	18"Wx18"D Molded Foam Oval Contoured Seat (A-7.25"xB-12.5" opening, 2.25" foam)	\$507
<input type="checkbox"/> <b>P61191</b>	18"Wx18"D Molded Gel Oval Contoured Seat (A-7.25"xB-12.5" opening, 2.5" gel)	\$591
<input type="checkbox"/> <b>P61192</b>	18"Wx18"D Molded Foam Front Open Contoured Seat (A-3.5"xB-7.25" opening, 2.25" foam)	\$507
<input type="checkbox"/> <b>P60993</b>	18"Wx18"D Comfortuff Front/Rear Open Seat (A-5"xB-8" opening, 2.5" waterfall foam)*	\$440
<input type="checkbox"/> <b>P60701</b>	18"Wx18"D Ensolite® Front/Rear Open Seat (A-4.5"xB-7.75", 1" foam)*	\$401
<input type="checkbox"/> <b>P61058</b>	18"Wx18"D Ensolite® Front Open Contoured Seat (A-5.5"xB-8.25" opening, 2" waterfall foam)	\$497
<input type="checkbox"/> <b>P61086</b>	18"Wx18"D Ensolite® Solid Seat (2" foam)	\$497
<input type="checkbox"/> <b>P60675</b>	18"Wx18"D Ensolite® Cloverleaf Seat (7.5"x9" oval opening, 1" foam)	\$401
<input type="checkbox"/> <b>P60850</b>	18"Wx18"D Ensolite® Front Open Seat (A-5"xB-8" opening, 1" waterfall foam)*	\$497
<input type="checkbox"/> <b>P60913</b>	18"Wx18"D Ensolite® Front/Rear Open Seat (A-5.25"xB-8" opening, 2" waterfall foam)*	\$497
<input type="checkbox"/> <b>P61121</b>	18"Wx20"D Ensolite® Front/Rear Open Seat (A-4.5"xB-7.5" opening, 1" foam)	\$670
<input type="checkbox"/> <b>P61122</b>	18"Wx20"D Ensolite® Solid Seat (1" foam)	\$670
<input type="checkbox"/> <b>PP60903</b>	18"Wx20"D Ensolite® Side Open Seat (A-4.5"xB-7.75" opening, 1" foam)	\$670
<input type="checkbox"/> <b>P60903</b>	20"Wx18"D Ensolite® Front/Rear Seat (A-4.5"xB-7.75" opening, 1" foam)	\$670
<input type="checkbox"/> <b>PP61122</b>	20"Wx18"D Ensolite® Solid Seat (1" foam)	\$670
<input type="checkbox"/> <b>P61038</b>	20"Wx18"D Comfortuff Front Open Seat (A-5"xB-8" opening, 1.5" waterfall foam)	\$670
<input type="checkbox"/> <b>P60905</b>	22"Wx18"D Ensolite® Front/Rear Seat (A-4.5"xB-7.75" opening, 1" foam)	\$761

\*Seat works in all 4 positions

Seat Opening Measurements  
1-Front End Opening  
2-Cloverleaf Seat Opening  
3-Oval Seat Opening

## Armrests - must select right and left armrest, must match frame depth

<input type="checkbox"/> <b>P13278</b>	18"D Left Hand Armrest with Pad	\$165
<input type="checkbox"/> <b>P13277</b>	18"D Right Hand Armrest with Pad	\$165
<input type="checkbox"/> <b>P13663</b>	20"D Left Hand Armrest with Pad	\$243
<input type="checkbox"/> <b>P13664</b>	20"D Right Hand Armrest with Pad	\$243

Altimate Medical products should only be used under the guidance of a physician and or therapist. Altimate Medical maintains a policy of continual product improvement and reserves the right to change features, specifications, and prices without prior notification. Check with Altimate Medical for latest information. FORM 600PL 103025 Copyright © 2026 Altimate Medical. All rights reserved. U.S. &amp; patents pending. Printed in the U.S.A.

## Email form to webquotes@altimatemedical.com

## Ship To:

Name:\_\_\_\_\_

Address:\_\_\_\_\_

City/State:\_\_\_\_\_

Zip:\_\_\_\_\_

Phone:\_\_\_\_\_

Tag For:\_\_\_\_\_

AltimateMedical  
creating products · changing lives

Ph: 800.342.8968 or 507.697.6393

Fax: 877.342.8968 or 507.697.6900

webquotes@altimatemedical.com activeaid.com

## Leg Rests - foot plate not included unless stated in description

<input type="checkbox"/> <b>PL13581</b>	Left Gooseneck Leg Rest	\$165
<input type="checkbox"/> <b>PR13581</b>	Right Gooseneck Leg Rest	\$165
<input type="checkbox"/> <b>P13582</b>	Left Elevating Leg Rest	\$634
<input type="checkbox"/> <b>P13583</b>	Right Elevating Leg Rest	\$634
<input type="checkbox"/> <b>P13667</b>	18"W 1-pc. Foot Plate/Leg Rest-must match frame width, foot plate included, P13670 required	\$350
<input type="checkbox"/> <b>P13668</b>	20"W 1-pc. Foot Plate/Leg Rest-must match frame width, foot plate included, P13670 required	\$361
<input type="checkbox"/> <b>P13669</b>	22"W 1-pc. Foot Plate/Leg Rest-must match frame width, foot plate included, P13670 required	\$373

## Foot Plates - cannot be ordered with one piece foot plate/leg rest

<input type="checkbox"/> <b>PL11099</b>	Left Foot Plate	\$24
<input type="checkbox"/> <b>PR11099</b>	Right Foot Plate	\$24
<input type="checkbox"/> <b>PL11100</b>	Left Foot Plate with Heel Loop	\$38
<input type="checkbox"/> <b>PR11100</b>	Right Foot Plate with Heel Loop	\$38
<input type="checkbox"/> <b>P13891</b>	Left Oversized Aluminum Foot Plate	\$189
<input type="checkbox"/> <b>P13892</b>	Right Oversized Aluminum Foot Plate	\$189
<input type="checkbox"/> <b>PL11101</b>	Left Padded Foot Plate	\$90
<input type="checkbox"/> <b>PR11101</b>	Right Padded Foot Plate	\$90

## Backs - frame, seat and back must match same widths, must select one

<input type="checkbox"/> <b>P13651</b>	18"W Sling Back with Stroller Handles	\$277
<input type="checkbox"/> <b>P13652</b>	18"W Solid Back	\$277
<input type="checkbox"/> <b>P13826</b>	18"W Contoured Back	\$485
<input type="checkbox"/> <b>P13658</b>	20"W Sling Back with Stroller Handles	\$367
<input type="checkbox"/> <b>P13659</b>	20"W Solid Back	\$367
<input type="checkbox"/> <b>P13661</b>	22"W Sling Back with Stroller Handles	\$457
<input type="checkbox"/> <b>P13662</b>	22"W Solid Back	\$457

## Belts

<input type="checkbox"/> <b>PW60909</b>	Waist Belt (for 18"W frame only, 54" circumference with 12" overlap)	\$80
<input type="checkbox"/> <b>PW60884</b>	Waist Belt (for 20"W and 22"W frames only, 66" and 68" circumference with 12" overlap)	\$80
<input type="checkbox"/> <b>PT60884</b>	Trunk Belt (64", 66" and 68" circumference with 12" overlap)	\$80
<input type="checkbox"/> <b>P60879</b>	Calf Strap (not available with P13582 and P13583 elevating leg rests)	\$80
<input type="checkbox"/> <b>P11093</b>	Bodypoint® Trunk Belt	\$243
<input type="checkbox"/> <b>P11102</b>	Bodypoint® Trunk Belt (pair)	\$458
<input type="checkbox"/> <b>P11116</b>	Bodypoint® Trunk Belt & Waist Belt	\$301
<input type="checkbox"/> <b>P11112</b>	Bodypoint® XL Trunk Belt	\$254
<input type="checkbox"/> <b>P11113</b>	Bodypoint® Belt w/Quick Release Knobs	\$282
<input type="checkbox"/> <b>P61170</b>	Bodypoint® Calf Strap (only available with 20"W, not available with P13582 and P13583 elevating leg rests)	\$159
<input type="checkbox"/> <b>P61081</b>	Bodypoint® Calf Strap (only available with 18" back, not available with P13582 and P13583 elevating leg rests)	\$159
<input type="checkbox"/> <b>P11114</b>	Bodypoint® Knee Belt	\$260

## Positioning Aids

<input type="checkbox"/> <b>PL13574</b>	Left Hand Swing-Away Adjustable Lateral	\$382
<input type="checkbox"/> <b>PR13574</b>	Right Hand Swing-Away Adjustable Lateral	\$382
<input type="checkbox"/> <b>PL13618</b>	Left Hand Arm-Mounted Hip Guide	\$364
<input type="checkbox"/> <b>PR13618</b>	Right Hand Arm-Mounted Hip Guide	\$364
<input type="checkbox"/> <b>P61006</b>	Abductor/Deflector-Large	\$242
<input type="checkbox"/> <b>P13670</b>	Front Anti-Tippers	\$294

## Pans - frame, seat and back must match same widths and depths

<input type="checkbox"/> <b>P13840</b>	18"Wx18"D Pan/Hanger	\$142
<input type="checkbox"/> <b>P13841</b>	18"Wx20"D Pan/Hanger	\$142
<input type="checkbox"/> <b>P13842</b>	20"Wx18"D Pan/Hanger	\$154
<input type="checkbox"/> <b>P13843</b>	22"Wx18"D Pan/Hanger	\$166

# 285 Rehab Shower/Commode Chair-Tilt

350 lb. Weight Capacity

Effective January 1, 2026

## Bill To:

Date:\_\_\_\_\_

P.O.#:\_\_\_\_\_

Quote#:\_\_\_\_\_

Account#:\_\_\_\_\_

Ordered By:\_\_\_\_\_

Supplier Company:\_\_\_\_\_

ATP (REQUIRED):\_\_\_\_\_

Address:\_\_\_\_\_

City, State, Zip:\_\_\_\_\_

Phone:\_\_\_\_\_

Email:\_\_\_\_\_

## Frames - frame, seat and back must match same widths, must select one

### Choose Frame Color

☐ Black ☐ White (if no selection is made, white will be selected)

☐ **P13636** 18"Wx18"D Stainless Steel Frame \$1,941

☐ SPECIAL SIZE 16"Wx18"D Stainless Steel Frame INQUIRE FOR PRICING

☐ SPECIAL SIZE 20"Wx18"D Stainless Steel Frame INQUIRE FOR PRICING

☐ SPECIAL SIZE 22"Wx18"D Stainless Steel Frame INQUIRE FOR PRICING

## Wheels/Rear Casters - must select one wheel or caster option

☐ **P60800-2** 5" Dual Locking Casters (pair) \$159

☐ **P13862** 24" Solid Shallow Tread Wheels (pair) \$530

☐ **P13864** 24" Pneumatic Deep Tread Wheels (pair) \$530

☐ **P13865** 24" Pneumatic Flat Free Deep Tread Wheels (pair) \$530

☐ **P13857** 24" PVC Handrims (replaces standard handrims, pair) \$312

## Axles - must select one if 24" wheels were selected

☐ **P13688** Bolted Axles with Anti-Tipping Levers (pair) \$61

## Wheel Locks - must select one if wheels were selected

☐ **P13975** Wheel Locks (pair) \$125

☐ **P13976** Wheel Locks with Extended Handle (pair) \$166

## Front Casters - must select one

☐ **P60841-2** 5" Casters (pair) \$136

☐ **P60800-2** 5" Dual Locking Casters (pair) \$159

## Seats - frame, seat and back must match same widths, must select one

☐ **P61189** 18"Wx18"D Molded Gel Front Open Contoured Seat (A-3.5"xB-7.25" opening, 2.5" gel) \$591

☐ **P61190** 18"Wx18"D Molded Foam Oval Contoured Seat (A-7.25"xB-12.5" opening, 2.25" foam) \$507

☐ **P61191** 18"Wx18"D Molded Gel Oval Contoured Seat (A-7.25"xB-12.5" opening, 2.5" gel) \$591

☐ **P61192** 18"Wx18"D Molded Foam Front Open Contoured Seat (A-3.5"xB-7.25" opening, 2.25" foam) \$507

☐ **P61124** 16"Wx18"D Ensolite® Front/Rear Open Seat (A-4.75"xB-7.75" opening, 1" foam) \$530

☐ **P60993** 18"Wx18"D Comfortuff Front/Rear Open Seat (A-5"xB-8" opening, 2.5" waterfall foam) \$440

☐ **P61058** 18"Wx18"D Ensolite® Front Open Contoured Seat (A-5.5"xB-8.25" opening, 2" waterfall foam) \$497

☐ **P60802** 18"Wx18"D Ensolite® Front Open Ring Seat (A-4.5"xB-7.75" opening, 1.25" foam) \$440

☐ **P61086** 18"Wx18"D Ensolite® Solid Seat (2" foam) \$497

☐ **P61121** 18"Wx20"D Ensolite® Front Open Seat (A-4.5"xB-7.5" opening, 1" foam) \$670

☐ **P61038** 20"Wx18"D Comfortuff Front Open Seat (A-5"xB-8" opening, 1.5" waterfall foam) \$670

☐ **P60903** 20"Wx18"D Ensolite® Front/Rear Open Seat (A-4.5"xB-7.75" opening, 1" foam) \$670

☐ **PP61122** 20"Wx18"D Ensolite® Solid Seat (1" foam) \$670

☐ **P60886** 20"Wx20"D Ensolite® Race Track Oval Seat (A-7.75"xB-12.75" opening, 1.5" foam) \$721

☐ **P61123** 20"Wx20"D Ensolite® Front/Rear Open Seat (A-4.5"xB-7.75" opening, 1" waterfall foam) \$721

☐ **P60905** 22"Wx18"D Ensolite® Front Open Seat (A-4.5"xB-7.75" opening, 1" foam) \$761

☐ **P60887** 22"Wx20"D Ensolite® Race Track Oval Seat (A-7.75"xB-12.75" opening, 1.5" foam) \$789

☐ **P61126** 22"Wx20"D Ensolite® Front/Rear Open Seat (A-4.5"xB-7.75" opening, 1" foam) \$811

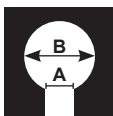
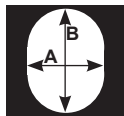
Front Open  
Seat Opening  
Measurements

Race Track Oval Seat  
Opening Measurements

## Armrests - must select right and left armrest

☐ **P13611** Left Hand Armrest with Pad \$181

☐ **P13612** Right Hand Armrest with Pad \$181

☐ **P13613** Left Hand Armrest with Arm Trough \$317

☐ **P13614** Right Hand Armrest with Arm Trough \$317

☐ **P13615** Left Hand Height-Adjustable Armrest \$345

☐ **P13616** Right Hand Height-Adjustable Armrest \$345

ActiveAid products should only be used under the guidance of a physician and or therapist. ActiveAid maintains a policy of continual product improvement and reserves the right to change features, specifications, and prices without prior notification. Check with ActiveAid for latest information. FORM 285PL 103025 Copyright © 2026 ActiveAid, Inc. All rights reserved. U.S. & international patents pending. Printed in the U.S.A.

## Email form to [webquotes@altimatemedical.com](mailto:webquotes@altimatemedical.com)

## Ship To:

Name:\_\_\_\_\_

Address:\_\_\_\_\_

City/State:\_\_\_\_\_

Zip:\_\_\_\_\_

Phone:\_\_\_\_\_

Tag For:\_\_\_\_\_



# AltimateMedical

creating products · changing lives

Ph: 800.342.8968 or 507.697.6393

Fax: 877.342.8968 or 507.697.6900

[webquotes@altimatemedical.com](mailto:webquotes@altimatemedical.com) [activeaid.com](http://activeaid.com)

## Leg Rests - foot plate not included

☐ **PL13581** Left Gooseneck Leg Rest \$165

☐ **PR13581** Right Gooseneck Leg Rest \$165

☐ **P13582** Left Elevating Leg Rest \$634

☐ **P13583** Right Elevating Leg Rest \$634

## Foot Plates

☐ **PL11099** Left Foot Plate \$24

☐ **PR11099** Right Foot Plate \$24

☐ **PL11100** Left Foot Plate with Heel Loop \$38

☐ **PR11100** Right Foot Plate with Heel Loop \$38

☐ **P13891** Left Oversized Aluminum Foot Plate \$189

☐ **P13892** Right Oversized Aluminum Foot Plate \$189

☐ **PL11101** Left Padded Foot Plate \$90

☐ **PR11101** Right Padded Foot Plate \$90

## Backs - frame, seat and back must match same widths, must select one

☐ **P61139** 16"W Adjustable Sling Back \$166

☐ **P11110** 16"W Solid Back \$644

☐ **P60877** 18"W Adjustable Sling Back \$177

☐ **P11107** 18"W Solid Back \$658

☐ **P60878** 20"W Adjustable Sling Back \$189

☐ **P11108** 20"W Solid Back \$682

☐ **P61140** 22"W Adjustable Sling Back \$201

☐ **P11109** 22"W Solid Back \$716

## Belts

☐ **PW60884** Waist Belt (62", 64", 66" or 68" circumference with 12" overlap) \$80

☐ **PT61180** Trunk Belt \$80

☐ **P60879** Calf Strap (not available with P13582 and P13583 elevating leg rests) \$80

☐ **P11093** Bodypoint® Trunk Belt \$243

☐ **P11102** Bodypoint® Trunk Belt (pair) \$458

☐ **P11116** Bodypoint® Trunk Belt & Waist Belt \$301

☐ **P11112** Bodypoint® XL Trunk Belt \$254

☐ **P11113** Bodypoint® Belt w/Quick Release Knobs \$282

☐ **P61169** Bodypoint® Calf Strap (only available with 16"W frame, not available with P13582 and P13583 elevating leg rests) \$159

☐ **P61170** Bodypoint® Calf Strap (only available with 20"W frame, not available with P13582 and P13583 elevating leg rests) \$159

☐ **P61081** Bodypoint® Calf Strap (only available with 18"W back, not available with P13582 and P13583 elevating leg rests) \$159

☐ **P11114** Bodypoint® Knee Belt \$260

## Positioning Aids

☐ **PL13574** Left Hand Swing-Away Adjustable Lateral \$382

☐ **PR13574** Right Hand Swing-Away Adjustable Lateral \$382

☐ **PL13618** Left Hand Arm-Mounted Hip Guide (not available with P13615 Armrests) \$364

☐ **PR13618** Right Hand Arm-Mounted Hip Guide (not available with P13616 Armrests) \$364

☐ **P61006** Abductor/Deflector-Large \$242

## Pans

☐ **P13831** Pan/Hanger for Ring and Contoured Seats \$142

☐ **P13832** Pan/Hanger for Front, Front/Rear, & Race Track Oval Seats \$142

## Head Supports

☐ **P13900** Head Support-Large \$418

☐ **P13913** Head Support-XL \$546



# 285TR Rehab Shower/Commode Chair-Tilt, Recline, Seat Height Adjustment

350 lb. Weight Capacity

Effective January 1, 2026

262 W. 1st Street  
Morton, MN 56270

Email form to [webquotes@altimatemedical.com](mailto:webquotes@altimatemedical.com)

## Bill To:

Date:\_\_\_\_\_

P.O.#:\_\_\_\_\_

Quote#:\_\_\_\_\_

Account#:\_\_\_\_\_

Ordered By:\_\_\_\_\_

Supplier Company:\_\_\_\_\_

ATP (REQUIRED):\_\_\_\_\_

Address:\_\_\_\_\_

City, State, Zip:\_\_\_\_\_

Phone:\_\_\_\_\_

Email:\_\_\_\_\_

## Frames - frame, seat back and pan must match same widths and depths, must select one

### Choose Frame Color

☐ Black ☐ White (if no selection is made, white will be selected)

<input type="checkbox"/> <b>P13763</b>	18"Wx18"D Stainless Steel Frame (height adjustable)	\$1,632
<input type="checkbox"/> SPECIAL SIZE	16"Wx18"D Stainless Steel Frame (height adjustable)	INQUIRE FOR PRICING
<input type="checkbox"/> SPECIAL SIZE	18"Wx20"D Stainless Steel Frame (height adjustable)	INQUIRE FOR PRICING
<input type="checkbox"/> SPECIAL SIZE	20"Wx18"D Stainless Steel Frame (height adjustable)	INQUIRE FOR PRICING
<input type="checkbox"/> SPECIAL SIZE	20"Wx20"D Stainless Steel Frame (height adjustable)	INQUIRE FOR PRICING
<input type="checkbox"/> SPECIAL SIZE	22"Wx18"D Stainless Steel Frame (height adjustable)	INQUIRE FOR PRICING
<input type="checkbox"/> SPECIAL SIZE	22"Wx20"D Stainless Steel Frame (height adjustable)	INQUIRE FOR PRICING

## Frame Positioning- must select one

<input type="checkbox"/> <b>P13759</b>	Tilt	\$553
<input type="checkbox"/> <b>P13760</b>	Recline	\$553
<input type="checkbox"/> <b>P13761</b>	Tilt/Recline	\$1,115

## Casters - must select one

<input type="checkbox"/> <b>P60800-4</b>	5" Dual Locking Casters (2 pair)	\$294
<input type="checkbox"/> <b>P13770</b>	5" Casters (pair) and 5" Dual Locking Casters (pair)	\$271

## Seats - frame, seat, back and pan must match same widths and depths, must select one

<input type="checkbox"/> <b>P61189</b>	18"Wx18"D Molded Gel Front Open Contoured Seat (A-3.5"xB-7.25" opening, 2.5" gel)	\$591
<input type="checkbox"/> <b>P61190</b>	18"Wx18"D Molded Foam Oval Contoured Seat (A-7.25"xB-12.5" opening, 2.25" foam)	\$507
<input type="checkbox"/> <b>P61191</b>	18"Wx18"D Molded Gel Oval Contoured Seat (A-7.25"xB-12.5" opening, 2.5" gel)	\$591
<input type="checkbox"/> <b>P61192</b>	18"Wx18"D Molded Foam Front Open Contoured Seat (A-3.5"xB-7.25" opening, 2.25" foam)	\$507
<input type="checkbox"/> <b>P61124</b>	16"Wx18"D Ensolite® Front Open Seat (A-4.75"xB-7.75" opening, 1" foam)	\$530
<input type="checkbox"/> <b>P60913</b>	18"Wx18"D Ensolite® Front/Rear Open Seat (A-5.25"xB-8" opening, 2" waterfall foam)	\$497
<input type="checkbox"/> <b>P60993</b>	18"Wx18"D Comfortuff Front/Rear Open Seat (A-5"xB-8D opening, 2.5" waterfall foam)*	\$440
<input type="checkbox"/> <b>P61058</b>	18"Wx18"D Ensolite® Front Open Contoured Seat (A-5.5"xB-8.25" opening, 2" waterfall foam)	\$497
<input type="checkbox"/> <b>P61086</b>	18"Wx18"D Ensolite® Solid Seat (2" foam)	\$497
<input type="checkbox"/> <b>P61122</b>	18"Wx20"D Ensolite® Solid Seat (1" foam)	\$632
<input type="checkbox"/> <b>P61121</b>	18"Wx20"D Ensolite® Front/Rear Open Seat (A-4.5"xB-7.5" opening, 1" foam)	\$670
<input type="checkbox"/> <b>PP61038</b>	18"Wx20"D Comfortuff Side Open Seat (A-5"xB-8" opening, 1.5" waterfall foam)	\$670
<input type="checkbox"/> <b>P61038</b>	20"Wx18"D Comfortuff Front Open Seat (A-5"xB-8" opening, 1.5" waterfall foam)	\$670
<input type="checkbox"/> <b>P60903</b>	20"Wx18"D Ensolite® Front/Rear Open Seat (A-4.5"xB-7.5" opening, 1" foam)	\$670
<input type="checkbox"/> <b>PP61121</b>	20"Wx18"D Ensolite® Side Open Seat (A-4.5"xB-7.5" opening, 1" foam)	\$670
<input type="checkbox"/> <b>PP61122</b>	20"Wx18"D Ensolite® Solid Seat (1" foam)	\$670
<input type="checkbox"/> <b>P61123</b>	20"Wx20"D Ensolite® Front/Rear Open Seat (A-5"xB-8" opening, 1" waterfall foam)*	\$721
<input type="checkbox"/> <b>P60905</b>	22"Wx18"D Ensolite® Front/Rear Open Seat (A-4.5"xB-7.5" opening, 1" foam)	\$761
<input type="checkbox"/> <b>P61126</b>	22"Wx20"D Ensolite® Front/Rear Open Seat (A-5"xB-8" opening, 1" waterfall foam)	\$811

\*Seat works in all 4 positions

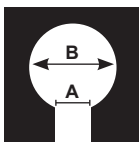

Seat Opening  
Measurements

## Armrests - must match frame depth, must select right and left armrest

<input type="checkbox"/> <b>P13729</b>	18"D Left Hand Armrest with Pad	\$176
<input type="checkbox"/> <b>P13730</b>	18"D Right Hand Armrest with Pad	\$176
<input type="checkbox"/> <b>P13731</b>	18"D Left Hand Armrest with Arm Trough	\$294
<input type="checkbox"/> <b>P13732</b>	18"D Right Hand Armrest with Arm Trough	\$294
<input type="checkbox"/> <b>P13735</b>	20"D Left Hand Armrest with Pad	\$238
<input type="checkbox"/> <b>P13736</b>	20"D Right Hand Armrest with Pad	\$238
<input type="checkbox"/> <b>P13737</b>	20"D Left Hand Armrest with Arm Trough	\$373
<input type="checkbox"/> <b>P13738</b>	20"D Right Hand Armrest with Arm Trough	\$373
<input type="checkbox"/> <b>P13563</b>	Left Hand Height-Adjustable Arms (P13564 required)	\$345
<input type="checkbox"/> <b>P13564</b>	Right Hand Height-Adjustable Arms (P13563 required)	\$345

## Ship To:

Name:\_\_\_\_\_

Address:\_\_\_\_\_

City/State:\_\_\_\_\_

Zip:\_\_\_\_\_

Phone:\_\_\_\_\_

Tag For:\_\_\_\_\_



## AltimateMedical

creating products · changing lives

Ph: 800.342.8968 or 507.697.6393

Fax: 877.342.8968 or 507.697.6900

[webquotes@altimatemedical.com](mailto:webquotes@altimatemedical.com) [activeaid.com](http://activeaid.com)

## Leg Rests - foot plate not included

<input type="checkbox"/> <b>PL13725</b>	Left Leg Rest	\$165
<input type="checkbox"/> <b>PR13725</b>	Right Leg Rest	\$165
<input type="checkbox"/> <b>P13571</b>	Left Elevating Leg Rest	\$634
<input type="checkbox"/> <b>P13572</b>	Right Elevating Leg Rest	\$634

## Foot Plates

<input type="checkbox"/> <b>PL11099</b>	Left Foot Plate	\$24
<input type="checkbox"/> <b>PR11099</b>	Right Foot Plate	\$24
<input type="checkbox"/> <b>PL11100</b>	Left Foot Plate with Heel Loop	\$38
<input type="checkbox"/> <b>PR11100</b>	Right Foot Plate with Heel Loop	\$38
<input type="checkbox"/> <b>P13891</b>	Left Oversized Aluminum Foot Plate	\$189
<input type="checkbox"/> <b>P13892</b>	Right Oversized Aluminum Foot Plate	\$189
<input type="checkbox"/> <b>PL11101</b>	Left Padded Foot Plate	\$90
<input type="checkbox"/> <b>PR11101</b>	Right Padded Foot Plate	\$90

## Backs - frame, seat, back and pan must match same widths and depths, must select one

<input type="checkbox"/> <b>P13745</b>	16"W Sling Back	\$591
<input type="checkbox"/> <b>P13746</b>	16"W Solid Back	\$929
<input type="checkbox"/> <b>P13747</b>	18"W Sling Back	\$647
<input type="checkbox"/> <b>P13748</b>	18"W Solid Back	\$977
<input type="checkbox"/> <b>P13750</b>	20"W Sling Back	\$721
<input type="checkbox"/> <b>P13751</b>	20"W Solid Back	\$1,025
<input type="checkbox"/> <b>P13752</b>	22"W Sling Back	\$838
<input type="checkbox"/> <b>P13753</b>	22"W Solid Back	\$1,142

## Belts

<input type="checkbox"/> <b>PW60884</b>	Waist Belt (62", 64", 66" or 68" circumference with 12" overlap)	\$80
<input type="checkbox"/> <b>PT60884</b>	Trunk Belt (62", 64", 66", or 68" circumference with 12" overlap)	\$80
<input type="checkbox"/> <b>P60879</b>	Calf Strap (not available with P13571 and P13572 elevating leg rests)	\$80
<input type="checkbox"/> <b>P11093</b>	Bodypoint® Trunk Belt	\$243
<input type="checkbox"/> <b>P11102</b>	Bodypoint® Trunk Belt (pair)	\$458
<input type="checkbox"/> <b>P11116</b>	Bodypoint® Trunk Belt & Waist Belt	\$301
<input type="checkbox"/> <b>P11112</b>	Bodypoint® XL Trunk Belt	\$254
<input type="checkbox"/> <b>P11113</b>	Bodypoint® Belt w/Quick Release Knobs	\$282
<input type="checkbox"/> <b>P61169</b>	Bodypoint® Calf Strap (only available with 16"W frame, not available with P13571 and P13572 elevating leg rests)	\$159
<input type="checkbox"/> <b>P61170</b>	Bodypoint® Calf Strap (only available with 20"W frame, not available with P13571 and P13572 elevating leg rests)	\$159
<input type="checkbox"/> <b>P61081</b>	Bodypoint® Calf Strap (only available with 18"W back, not available with P13571 and P13572 elevating leg rests)	\$159
<input type="checkbox"/> <b>P11114</b>	Bodypoint® Knee Belt	\$260

## Positioning Aids

<input type="checkbox"/> <b>PL13574</b>	Left Hand Swing-Away Adjustable Lateral	\$382
<input type="checkbox"/> <b>PR13574</b>	Right Hand Swing-Away Adjustable Lateral	\$382
<input type="checkbox"/> <b>PL13618</b>	Left Hand Arm-Mounted Hip Guide (not available with P13563 Armrests)	\$364
<input type="checkbox"/> <b>PR13618</b>	Right Hand Arm-Mounted Hip Guide (not available with P13564 Armrests)	\$364
<input type="checkbox"/> <b>P61006</b>	Abductor/Deflector-Large	\$242

## Pans - frame, seat, back and pan must match same widths and depths

<input type="checkbox"/> <b>P13833</b>	16"Wx18"D Pan/Hanger	\$142
<input type="checkbox"/> <b>P13834</b>	18"Wx18"D Pan/Hanger	\$142
<input type="checkbox"/> <b>P13835</b>	18"Wx20"D Pan/Hanger	\$154
<input type="checkbox"/> <b>P13836</b>	20"Wx18"D Pan/Hanger	\$166
<input type="checkbox"/> <b>P13837</b>	20"Wx20"D Pan/Hanger	\$177
<input type="checkbox"/> <b>P13838</b>	22"Wx18"D Pan/Hanger	\$189
<input type="checkbox"/> <b>P13839</b>	22"Wx20"D Pan/Hanger	\$201

## Head Supports

<input type="checkbox"/> <b>P13900</b>	Head Support-Large	\$418
<input type="checkbox"/> <b>P13913</b>	Head Support-XL	\$546